



STANDARD DETAIL SET FOR FORTIFIED ROOF™

2019

FORTIFIED Home™ Standard Details Table of Contents

<u>Detail Number</u>	<u>Detail Title</u>
F-G-1	Corrosion Protection Requirements
F-G-2	Roof and Wall Zone Diagram
F-RS-1	Roof Deck Attachment - Sawn Lumber or Wood Board Roof Deck with No Gaps
F-RS-2	Hurricane - New Construction Roof Deck Attachment - Structural Wood Panels
F-RS-3	High Wind - New Construction Roof Deck Attachment - Structural Wood Panels
F-SRD-1	Roof Deck Attachment and Sealed Roof Deck from Within Using Spray Foam
F-SRD-2	Sealed Roof Deck - Flashing Tape and Underlayment- Shingle or Metal Roof Covers, Steep Slope
F-SRD-3	Sealed Roof Deck - Two Layers Felt Underlayment - Shingle or Metal Roof Covers, Steep Slope
F-SRD-4	Sealed Roof Deck - Self-Adhered Membrane (Showing Bond Break for Asphalt Shingles) - Shingle, Metal, Concrete and Clay Tile Roof Covers, Steep Slope
F-SRD-5	Sealed Roof Deck - Flashing Tape, Underlayment and Roof Tile Cap Sheet - Concrete and Clay Tile Roof Covers, Steep Slope
F-DE-1	Hurricane - Drip Edge Installation Over Underlayment
F-DE-2	Drip Edge Installation Over Anchor Sheet and Under Cap Sheet for Concrete and Clay Tile Roof Covers
F-DE-3	High Wind - Drip Edge Installation Over Underlayment
F-RC-1	Asphalt Shingle Installation Guidance for Steep Slope - Option 1: Peel and Stick Starter Strip Installation at Eave or Rake
F-RC-2	Asphalt Shingle Installation Guidance for Steep Slope - Option 2: Single Strip Starter Installation at Eave or Rake
F-RC-3	Asphalt Shingle Installation Guidance for Steep Slope - Option 3: Shingles Set Directly in Flashing Cement at Rake Only
F-RR-1	Re-Roofing Deck Replacement Fastening Detail
F-RR-2	Re-Roofing New Scab Member Detail for Damaged or Deteriorated Wood Framing Member
F-RR-3	Hurricane - Re-Nailing the Roof Deck (Wood Structural Panels)
F-RR-4	High Wind - Re-Nailing the Roof Deck (Wood Structural Panels)
F-GS-1	Gable Vent Shuttering

FORTIFIED Home™ Standard Details Naming Convention

FORTIFIED Home™ Standard Detail numbers are comprised of three alphanumeric identifications to provide general categorization:

1. First alphabetic identification – FORTIFIED Detail:
 - F = FORTIFIED
2. Second alphabetic identification – Secondary Category
 - G = General Information
 - RS = Roof Sheathing
 - SRD = Sealed Roof Deck
 - DE = Drip Edge
 - RC = Roof Cover
 - RR = Re-Roof
 - GS = Gable Shuttering
3. Numeric identification – chronological order detail was completed

Example: F-RS-1

Fortified Detail → Roof Sheathing Detail → First Detail in this category

FORTIFIED Fastener and Connector Corrosion Protection Requirements

Fasteners/Connectors	Structures within 300 ft of saltwater	Structures more than 300 ft but less than 1,000 ft from saltwater ¹	Structures more than 1,000 ft but less than 3,000 ft from saltwater	Structures more than 3,000 ft from saltwater
Roofing nails for shingles	Stainless steel	Stainless steel	Hot-dip galvanized ⁴	Corrosion resistant ⁵
Concrete and clay roof tile fasteners	Stainless steel	Stainless steel	Hot-dip galvanized ⁴	Corrosion resistant ⁵
Metal roof clips and fasteners (exposed)	Stainless steel	Stainless steel	Stainless steel	Corrosion resistant ⁵
Fasteners used for attachment of underlayment to roof deck	Hot-dip galvanized ⁴	Hot-dip galvanized ⁴	Hot-dip galvanized ⁴	Corrosion resistant ⁵
Aluminum soffits	Not allowed	Not allowed	Allowed	Allowed
Soffit and roof vent fasteners	Stainless steel	Stainless steel	Stainless steel	Corrosion resistant ⁵
Metal framing connectors, fasteners, anchors, and hangers in exposed areas ²	Stainless steel	Stainless steel	Stainless steel	Stainless steel or G185 galvanized coating
Metal framing connectors, fasteners, anchors, and hangers in vented enclosed areas ³	Stainless steel	Stainless steel or G185 galvanized coating	Stainless steel or G185 galvanized coating	Corrosion resistant ⁵

Notes:

- Buildings on open, elevated foundations within 1,000 ft of saltwater shall follow the requirements of structures within 300 ft of saltwater.
- Examples of exposed areas include areas that are under roof overhangs, decks and covered walkways or in any location that is openly or partially exposed to saltwater air.
- Examples of vented enclosed areas include attics with vents.
- Hot-dip galvanized shall meet the requirements of ASTM A153, Class D for nails and screws.
- Corrosion-resistant nails and screws shall meet the requirements of ASTM A 641, Class 1, or an equal corrosion resistance by coating, galvanization, stainless steel, or other suitable corrosion-resistant material. Corrosion-resistant sheet metal connectors, anchors, and hangers shall meet the requirements of ASTM A653, G90.

APPLICABLE STANDARDS:

FORTIFIED HOME™ - HURRICANE (2019)
FORTIFIED HOME™ - HIGH WIND (2015)

DESCRIPTION:

CORROSION PROTECTION
REQUIREMENTS

DRAWING #:

F-G-1

DATE:

11/18/2019



INTERIOR ZONES
ROOFS - ZONE 1/ WALLS - ZONE 4

END ZONES
ROOFS - ZONE 2/ WALLS - ZONE 5

CORNER ZONES
ROOFS - ZONE 3

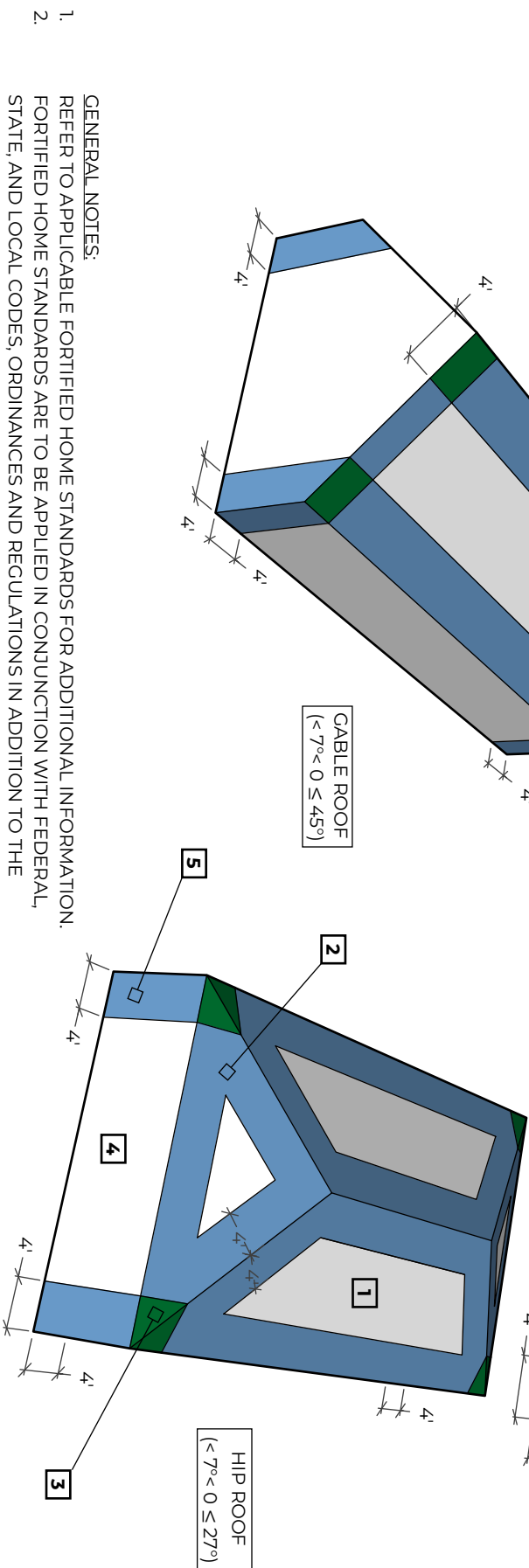
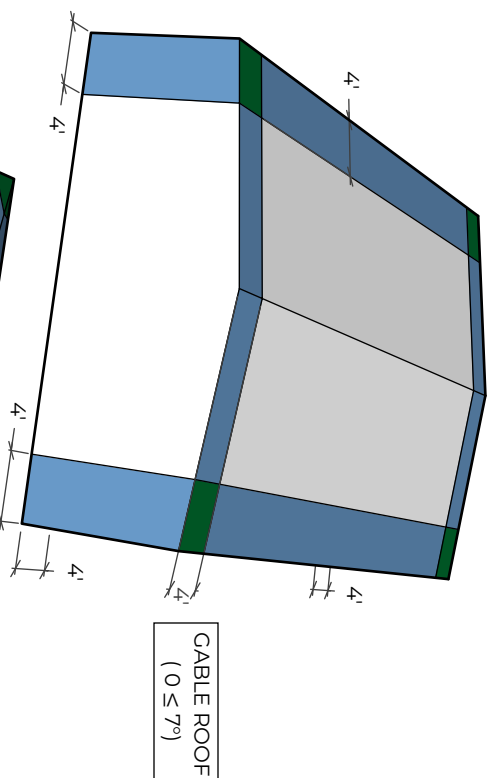
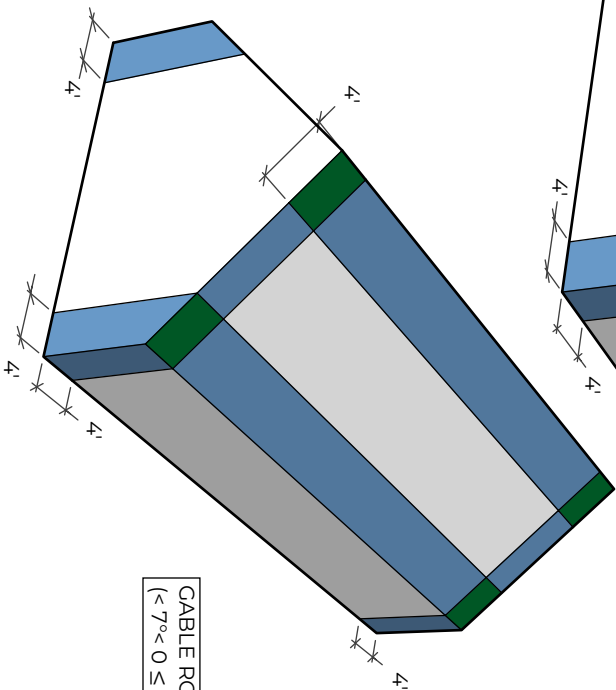
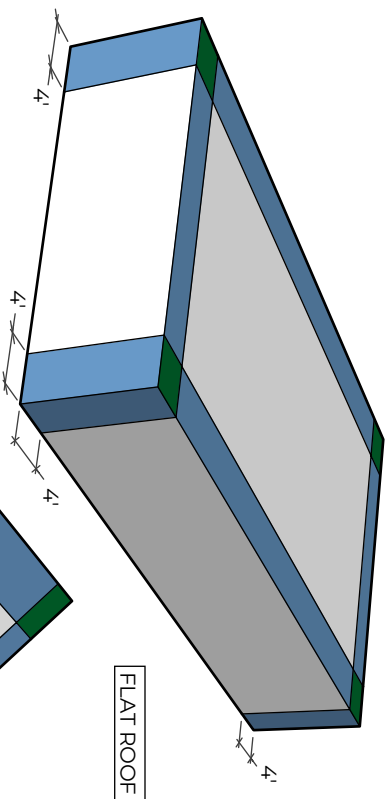

- GENERAL NOTES:
1. REFER TO APPLICABLE FORTIFIED HOME STANDARDS FOR ADDITIONAL INFORMATION.
 2. FORTIFIED HOME STANDARDS ARE TO BE APPLIED IN CONJUNCTION WITH FEDERAL, STATE, AND LOCAL CODES, ORDINANCES AND REGULATIONS IN ADDITION TO THE STRUCTURAL DESIGN WHICH IS BY OTHERS. IN CASE OF A CONFLICT BETWEEN PROVISIONS, USE WHICHEVER IS MORE STRINGENT.

APPLICABLE STANDARDS:

FORTIFIED HOME™ - HURRICANE (2019)
FORTIFIED HOME™ - HIGH WIND (2015)

DESCRIPTION:

ROOF AND WALL ZONE DIAGRAM

DRAWING #:

F-G-2

DATE: 11/18/2019



- GENERAL NOTES:**
1. REFER TO APPLICABLE FORTIFIED HOME STANDARDS FOR ADDITIONAL INFORMATION.
 2. APPLICABLE FOR SHINGLE OR METAL ROOF COVERS.
 3. APPLICABLE FOR ROOF PITCH 2:12 OR GREATER.
 4. FORTIFIED HOME STANDARDS ARE TO BE APPLIED IN CONJUNCTION WITH FEDERAL, STATE, AND LOCAL CODES, ORDINANCES AND REGULATIONS IN ADDITION TO THE STRUCTURAL DESIGN WHICH IS BY OTHERS. IN CASE OF A CONFLICT BETWEEN PROVISIONS, USE WHICHEVER IS MORE STRINGENT.

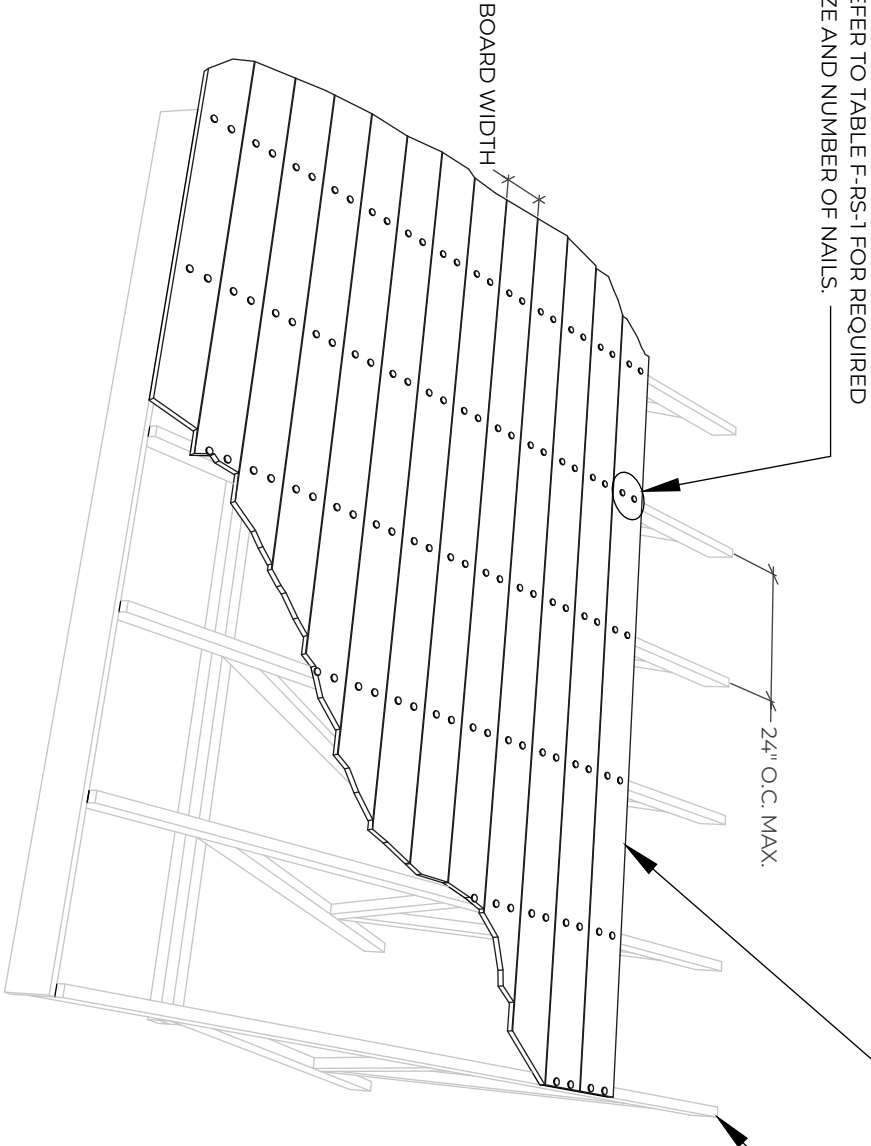

MINIMUM 1X SAWN LUMBER OR WOOD BOARD ROOF DECK BY OTHERS.

ROOF FRAMING MEMBERS W/ 2" MIN. NOMINAL THICKNESS.

Table F-RS-1: FASTENERS REQUIRED FOR WOOD BOARD DECKING ATTACHMENT.

WOOD BOARD/LUMBER (ROOF DECKING) WIDTH	NUMBER AND MINIMUM DIMENSIONS OF NAILS PER BOARD FOR EACH FRAMING MEMBER IT CROSSES
UP TO 8".	TWO(2) 0.131" Ø MIN. W/ 1 - 5/8" PENETRATION INTO ROOF FRAMING MEMBERS (MIN. LENGTH OF NAIL= 2 - 1/2")
LARGER THAN 8".	THREE(3) 0.131" Ø MIN. W/ 1 - 5/8" PENETRATION INTO ROOF FRAMING MEMBERS (MIN. LENGTH OF NAIL= 2 - 1/2")

NOTE: CLIPPED-HEAD, D-HEAD, OR ROUND-HEAD NAILS SHALL BE ACCEPTABLE PROVIDED THEY HAVE THE REQUIRED MINIMUM DIAMETER AND LENGTH.

APPLICABLE STANDARDS:

FORTIFIED HOME™ - HURRICANE (2019)
FORTIFIED HOME™ - HIGH WIND (2015)

DESCRIPTION:

ROOF DECK ATTACHMENT - SAWN LUMBER
OR WOOD BOARD ROOF DECK WITH NO
GAPS

DRAWING #:

F-RS-1

DATE:

11/18/2019



GENERAL NOTES:

1. REFER TO APPLICABLE FORTIFIED HOME STANDARDS FOR ADDITIONAL INFORMATION.
2. APPLICABLE FOR SHINGLE OR METAL ROOF COVERS.
3. APPLICABLE FOR ROOF PITCH 2:12 OR GREATER.
4. FOR CONCRETE AND CLAY TILE ROOF COVERS, MINIMUM SHEATHING THICKNESS IS 15/32."
5. FORTIFIED HOME STANDARDS ARE TO BE APPLIED IN CONJUNCTION WITH FEDERAL, STATE, AND LOCAL CODES, ORDINANCES, AND REGULATIONS IN ADDITION TO THE STRUCTURAL DESIGN WHICH IS BY OTHERS. IN CASE OF A CONFLICT BETWEEN PROVISIONS, USE WHICHEVER IS MORE STRINGENT.

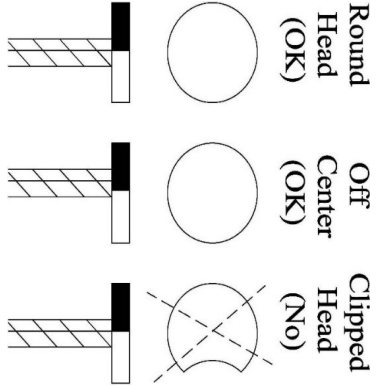
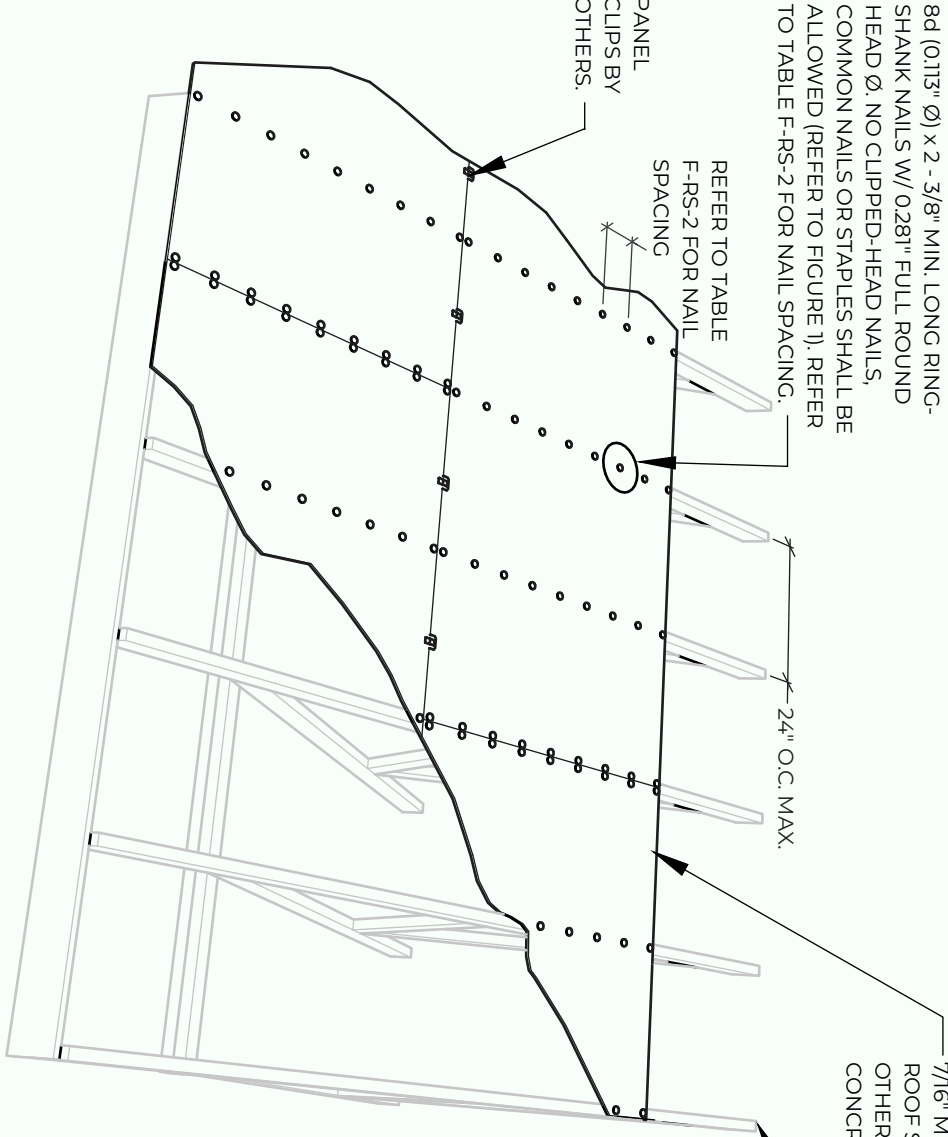

FIGURE 1.

Table F-RS-2: MAXIMUM ALLOWED RING SHANK NAIL SPACING ALONG PANEL EDGES AND INTERMEDIATE FRAMING FOR ATTACHING ROOF DECK WOOD STRUCTURAL PANELS.

DESIGN WIND SPEED		ALL ROOF AREAS
ASCE 7-05 (Vasd)	ASCE 7-10 (Vasd)	
110 MPH OR LESS	130 MPH OR LESS	6" O.C.
GREATER THAN 110 MPH	GREATER THAN 130 MPH	4" O.C.

APPLICABLE STANDARDS:

FORTIFIED HOME™ - HURRICANE (2019)

DESCRIPTION:

HURRICANE - NEW CONSTRUCTION
ROOF DECK ATTACHMENT -
STRUCTURAL WOOD PANELS

DRAWING #:

F-RS-2

DATE:

11/18/2019



GENERAL NOTES:

1. REFER TO APPLICABLE FORTIFIED HOME STANDARDS FOR ADDITIONAL INFORMATION.
2. APPLICABLE FOR SHINGLE OR METAL ROOF COVERS.
3. APPLICABLE FOR ROOF PITCH 2:12 OR GREATER.
4. SHEATHING THICKNESS REQUIREMENTS:
FOR GOLD DESIGNATION: 7/16" MIN. SHEATHING THICKNESS W/ ROOF MEMBERS @ 24" O.C. MAX. IS REQUIRED.
FOR ROOF/SILVER DESIGNATIONS: 3/8" MIN. SHEATHING THICKNESS IS PERMITTED WHEN ROOF MEMBERS ARE @ 16" O.C. MAX.
5. FOR CONCRETE AND CLAY TILE ROOF COVERS, MINIMUM SHEATHING THICKNESS IS 15/32" TO BE ELIGIBLE FOR GOLD DESIGNATION. ROOF MEMBERS MUST BE DESIGNED FOR MINIMUM 110 MPH 3-SECOND GUST (ASD)
6. DESIGN WIND LOADS FOR TERRAIN EXPOSURE B.
7. FORTIFIED HOME STANDARDS ARE TO BE APPLIED IN CONJUNCTION WITH FEDERAL, STATE, AND LOCAL CODES, ORDINANCES AND REGULATIONS IN ADDITION TO THE STRUCTURAL DESIGN WHICH IS BY OTHERS. IN CASE OF A CONFLICT BETWEEN PROVISIONS, USE WHICHEVER IS MORE STRINGENT.

REFER TO TABLE F-RS-3 FOR NAIL MINIMUM DIMENSIONS AND SPACING REQUIREMENTS.

REFER TO GENERAL NOTE #4 FOR ROOF MEMBER SPACING REQUIREMENTS.

STRUCTURAL WOOD PANEL ROOF SHEATHING (PLYWOOD OR OSB) BY OTHERS. REFER TO GENERAL NOTES #4 AND #5 FOR SHEATHING THICKNESS REQUIREMENTS.

ROOF FRAMING MEMBERS W/ 2" MIN. NOMINAL THICKNESS. REFER TO GENERAL NOTE #6.

Table F-RS-3: MAXIMUM ALLOWED NAIL SPACING ALONG PANEL EDGES AND INTERMEDIATE FRAMING FOR ATTACHING ROOF DECK WOOD STRUCTURAL PANELS.

MINIMUM NAILS USED FOR SHEATHING ATTACHMENT TO ROOF STRUCTURAL MEMBERS		MAX. NAIL SPACING (ALL ROOF AREAS)
8D (0.113" Ø) X 2 - 3/8" LONG RINK-SHANK NAILS W/ 0.281" FULL ROUND HEAD		6" O.C.
8D (0.131" Ø) X 2 - 1/2" LONG COMMON NAILS W/ 0.281" FULL ROUND HEAD		4" O.C.

NOTE: NO CLIPPED HEAD NAILS SHALL BE ALLOWED. REFER TO FIGURE 1.

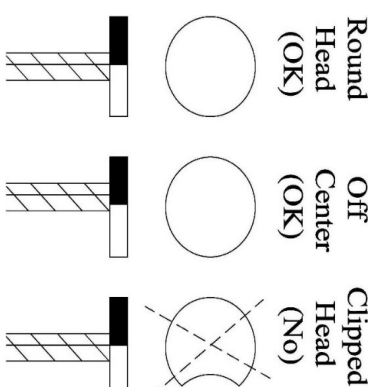
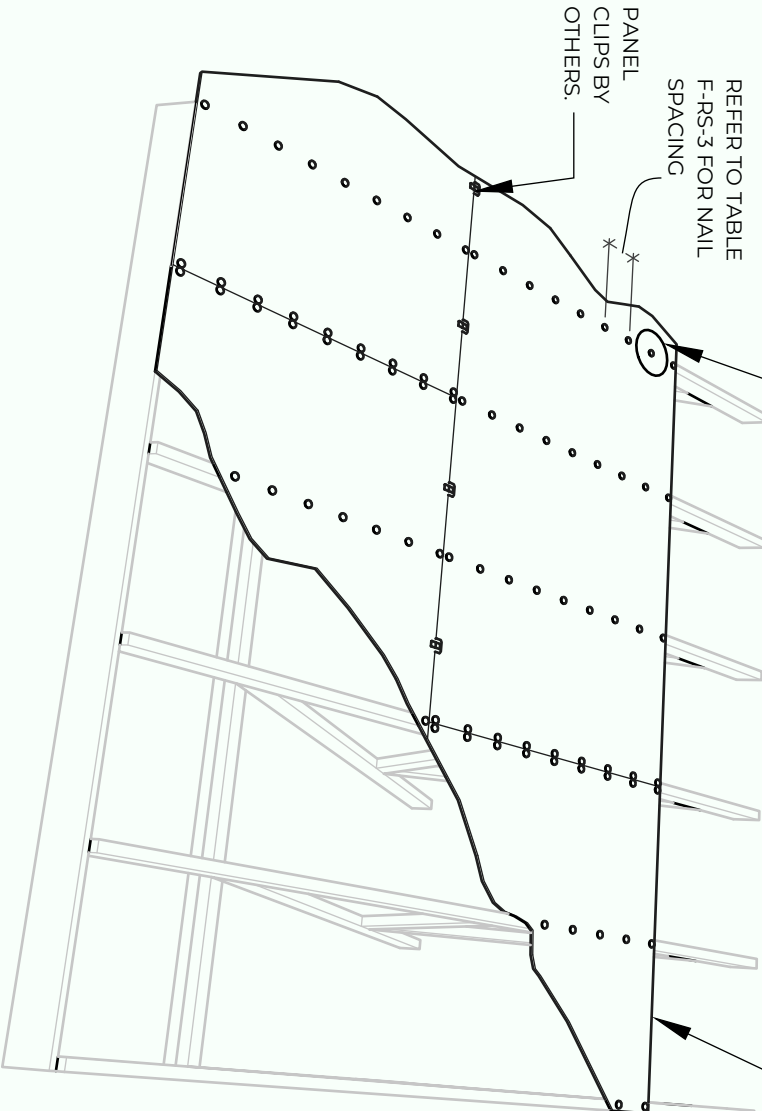

FIGURE 1.

APPLICABLE STANDARDS:

FORTIFIED HOME™ - HIGH WIND (2015)

DESCRIPTION:

HIGH WIND - NEW CONSTRUCTION
ROOF DECK ATTACHMENT -
STRUCTURAL WOOD PANELS

DRAWING #:

F-RS-3

DATE:

11/18/2019



MINIMUM REQUIREMENTS FOR SPRAY ADHESIVES:

1. PRODUCT MUST BE TESTED AND EVALUATED IN ACCORDANCE WITH EITHER ASTM E330, STANDARD TEST METHOD FOR STRUCTURAL PERFORMANCE OF EXTERIOR WINDOWS, DOORS, SKYLIGHTS, AND CURTAIN WALLS BY UNIFORM STATIC AIR PRESSURE DIFFERENCE (APPLIED TO ROOF SHEATHING) OR TAS 202-94, CRITERIA FOR TESTING IMPACT AND NON-IMPACT RESISTANT BUILDING ENVELOPE COMPONENTS USING UNIFORM STATIC AIR PRESSURE. THE MINIMUM ALLOWABLE DESIGN UPLIFT PRESSURE MUST BE GREATER THAN OR EQUAL TO 110 PSF AND THE PROOF TEST PRESSURE ACHIEVED WITHOUT FAILURE OR STRUCTURAL DISTRESS MUST BE GREATER THAN OR EQUAL TO 165 PSF.
2. ADHESIVE MUST BE A TWO-COMPONENT SPRAY POLYURETHANE FOAM SYSTEM WITH A MINIMUM CORE DENSITY OF 15-3.0 PCF IN ACCORDANCE WITH ASTM D1622, STANDARD TEST METHOD FOR APPARENT DENSITY OF RIGID CELLULAR PLASTICS.
3. SPRAY POLYURETHANE FOAM ADHESIVE SYSTEM MUST BE INSTALLED BY A PROPERLY TRAINED AND QUALIFIED APPLICATOR IN ACCORDANCE WITH THE MANUFACTURER'S MAINTENANCE AND INSTALLATION GUIDELINES. DOCUMENTATION FROM THE INSTALLING CONTRACTOR, ON COMPANY LETTERHEAD, IDENTIFYING THE MANUFACTURER AND PRODUCT USED FOR THE IMPROVED ROOF SHEATHING ATTACHMENT/SEALED ROOF DECK MUST BE PROVIDED TO THE CERTIFIED EVALUATOR TO BE INCLUDED WITH FINAL DESIGNATION CHECKLIST. DOCUMENTATION SHOULD ALSO STATE THAT THE INSTALLATION MEETS THE MANUFACTURERS REQUIREMENTS FOR AN ALLOWABLE DESIGN UPLIFT PRESSURE OF AT LEAST 110 PSF (PROOF TEST OF AT LEAST 165 PSF).
5. **USE THE MINIMUM DENSITY AND INSTALLATION REQUIREMENTS PRESCRIBED BY THE MANUFACTURER TO MEET A MINIMUM DESIGN UPLIFT PRESSURE ON THE SHEATHING OF 110 PSF FOR HURRICANE OR 80 PSF FOR HIGH WIND.**

GENERAL NOTES:

REFER TO APPLICABLE FORTIFIED HOME STANDARDS FOR ADDITIONAL INFORMATION. EXISTING SHEATHING REQUIREMENTS: FOR HURRICANE: 7/6" MIN. THICKNESS REQUIRED WITH ROOF MEMBERS @ 24" O.C. MAX.
FOR HIGH WIND: 7/6" MIN. THICKNESS IS REQUIRED FOR GOLD DESIGNATION. FOR ROOF/SILVER DESIGNATION, 3/8" MIN. THICKNESS IS PERMITTED WHEN ROOF MEMBERS ARE 16" O.C. MAX.
FORTIFIED HOME STANDARDS ARE TO BE APPLIED IN CONJUNCTION WITH FEDERAL, STATE, AND LOCAL CODES, ORDINANCES AND REGULATIONS IN ADDITION TO THE STRUCTURAL DESIGN WHICH IS BY OTHERS. IN CASE OF A CONFLICT BETWEEN PROVISIONS, USE WHICHEVER IS MORE STRINGENT.

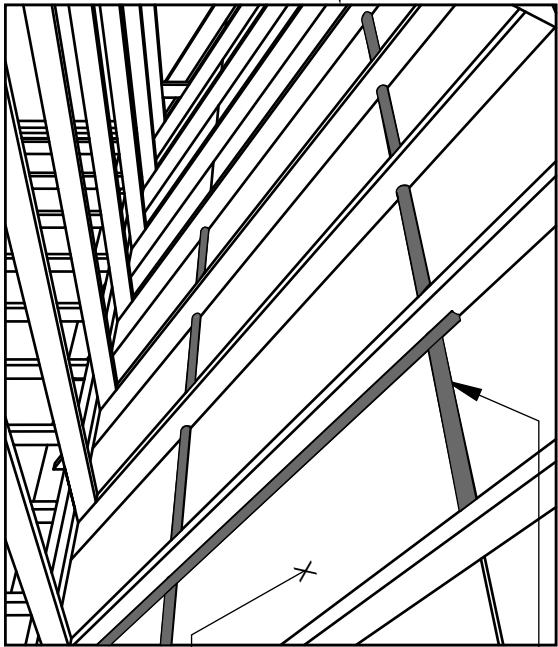
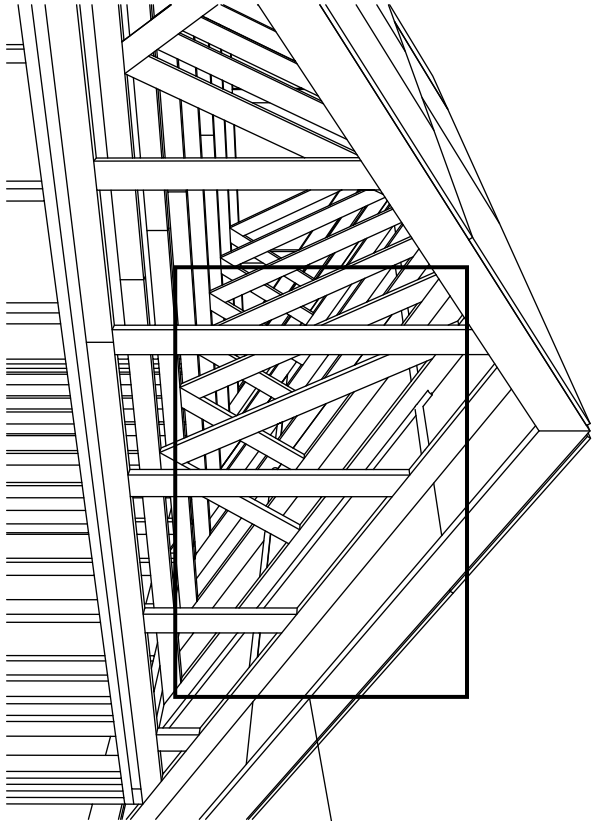

1.5" TO 3" FILLET OF 2-PART SPRAY-APPLIED CLOSED CELL POLYURETHANE FOAM ADHESIVE AT ALL JOINTS BETWEEN SHEATHING AND AT ALL INTERSECTIONS BETWEEN ROOF SHEATHING AND ROOF FRAMING MEMBERS, AND AT ALL VALLEYS. REFER TO MINIMUM REQUIREMENTS FOR SPRAY ADHESIVES.
EXISTING STRUCTURAL WOOD PANEL ROOF SHEATHING BY OTHERS. REFER TO GENERAL NOTE #2 FOR REQUIREMENTS.

UNDERSIDE OF ROOF DECK FROM WITHIN ATTIC

APPLICABLE STANDARDS:

FORTIFIED HOME™ - HURRICANE (2019)
FORTIFIED HOME™ - HIGH WIND (2015)

DESCRIPTION:

ROOF DECK ATTACHMENT AND SEALED ROOF DECK FROM WITHIN USING SPRAY FOAM

DRAWING #:

F-SRD-1

DATE:

11/18/2019



GENERAL NOTES:

1. REFER TO APPLICABLE FORTIFIED HOME STANDARDS FOR ADDITIONAL INFORMATION.
2. REFER TO FORTIFIED STANDARD DETAIL F-G-1 FOR CORROSION PROTECTION REQUIREMENTS.
3. APPLICABLE FOR ROOF PITCH 2:12 OR GREATER.
4. FORTIFIED HOME STANDARDS ARE TO BE APPLIED IN CONJUNCTION WITH FEDERAL, STATE, AND LOCAL CODES, ORDINANCES AND REGULATIONS IN ADDITION TO THE STRUCTURAL DESIGN WHICH IS BY OTHERS. IN CASE OF A CONFLICT BETWEEN PROVISIONS, USE WHICHEVER IS MORE STRINGENT.

FLASHING TAPE AT ALL PANEL SEAMS FULLY ADHERED W/ NO WRINKLES OR VOIDS USING ROLLER.

MATERIAL OPTION 1: 4" WIDE ASTM D1970 COMPLIANT SELF-ADHERING POLYMER-MODIFIED BITUMEN FLASHING TAPE.

MATERIAL OPTION 2: 3 - 1/4" WIDE AAMA 711-13 LEVEL 3 (FOR EXPOSURE UP TO 80°C/176°F) COMPLIANT SELF-ADHERING FLASHING TAPE.

ASTM D226 TYPE II #30 OR ASTM D4869 TYPE III OR TYPE IV #30 UNDERLAYMENT. (FOR ASPHALT SHINGLE ROOF COVERS, ASTM D6757 UNDERLAYMENT IS ALSO ACCEPTABLE)

ALT: REINFORCED SYNTHETIC ROOF UNDERLAYMENT WITH ICC APPROVAL AS ASTM D226 TYPE II ; MINIMUM TEAR STRENGTH = 15 LBF PER ASTM D4533 MINIMUM TENSILE STRENGTH = 20 PSF PER ASTM D5035 HORIZONTAL LAPS = 4" MIN.

END LAPS = 6" MIN.

TACK UNDERLAYMENT IN PLACE WITH ROOFING NAILS ONLY AT EDGES. DO NOT INSTALL CAPS AT EDGES UNTIL DRIP EDGE IS IN PLACE. REFER TO F-DE-1 AND F-DE-3 FOR DRIP EDGE INSTALLATION.

ROOF SHEATHING ; REFER TO FORTIFIED STANDARD DETAILS F-RS-1, F-RS-2, AND F-RS-3.

6" MIN. OVERLAP FOLDED OVER RIDGE ON BOTH SIDES.

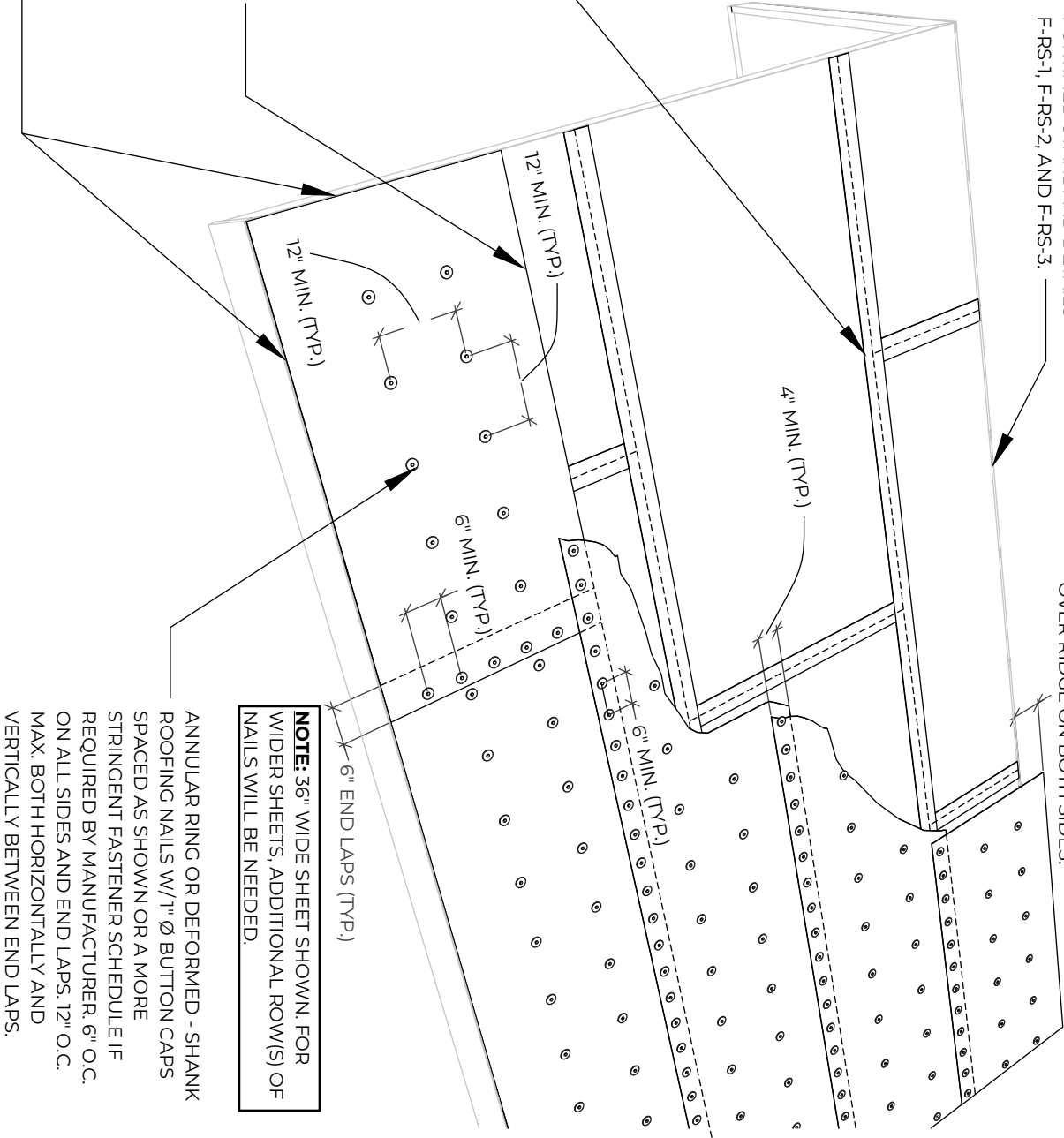

NOTE: 36" WIDE SHEET SHOWN. FOR WIDER SHEETS, ADDITIONAL ROW(S) OF NAILS WILL BE NEEDED.

ANNULAR RING OR DEFORMED - SHANK ROOFING NAILS W/ 1" Ø BUTTON CAPS SPACED AS SHOWN OR A MORE STRINGENT FASTENER SCHEDULE IF REQUIRED BY MANUFACTURER. 6" O.C. ON ALL SIDES AND END LAPS. 12" O.C. MAX. BOTH HORIZONTALLY AND VERTICALLY BETWEEN END LAPS.

APPLICABLE STANDARDS:

FORTIFIED HOME™ - HURRICANE (2019)
FORTIFIED HOME™ - HIGH WIND (2015)

DESCRIPTION:

SEALED ROOF DECK - FLASHING TAPE AND UNDERLAYMENT - SHINGLE OR METAL ROOF COVERS, STEEP SLOPE

DRAWING #:

F-SRD-2

DATE:

11/18/2019



REFER TO APPLICABLE FORTIFIED HOME STANDARDS FOR ADDITIONAL INFORMATION.
REFER TO FORTIFIED STANDARD DETAIL F-G-1 FOR CORROSION PROTECTION REQUIREMENTS.
WEAVE UNDERLAYMENT ACROSS VALLEYS.
DOUBLE LAP UNDERLAYMENT ACROSS RIDGES (UNLESS THERE IS A CONTINUOUS RIDGE VENT).
LAP UNDERLAYMENT WITH MINIMUM 6" LEG. "TURNED UP" AT WALL INTERSECTIONS; LAP WALL WEATHER BARRIER OVER TURNED-UP ROOF UNDERLAYMENT.
APPLICABLE FOR ROOF PITCH 2:12 OR GREATER.
FORTIFIED HOME STANDARDS ARE TO BE APPLIED IN CONJUNCTION WITH FEDERAL, STATE, AND LOCAL CODES, ORDINANCES AND REGULATIONS IN ADDITION TO THE STRUCTURAL DESIGN WHICH IS BY OTHERS. IN CASE OF A CONFLICT BETWEEN PROVISIONS, USE WHICHEVER IS MORE STRINGENT.

ROOF SHEATHING BY OTHERS; REFER TO FORTIFIED STANDARD DETAILS F-RS-1, F-RS-2, AND F-RS-3. —

DESIGN WIND SPEED		NAIL AND CAP TYPE
ASCE 7-05 (Vasd)	ASCE 7-10 (Vult)	
LESS THAN 140 MPH	LESS THAN 160 MPH	ANNULAR RING OR DEFORMED SHANK NAILS W/ 1" Ø BUTTON CAPS
140 MPH OR GREATER	160 MPH OR GREATER	ANNULAR RING OR DEFORMED SHANK NAILS W/ 1" Ø TIN CAPS

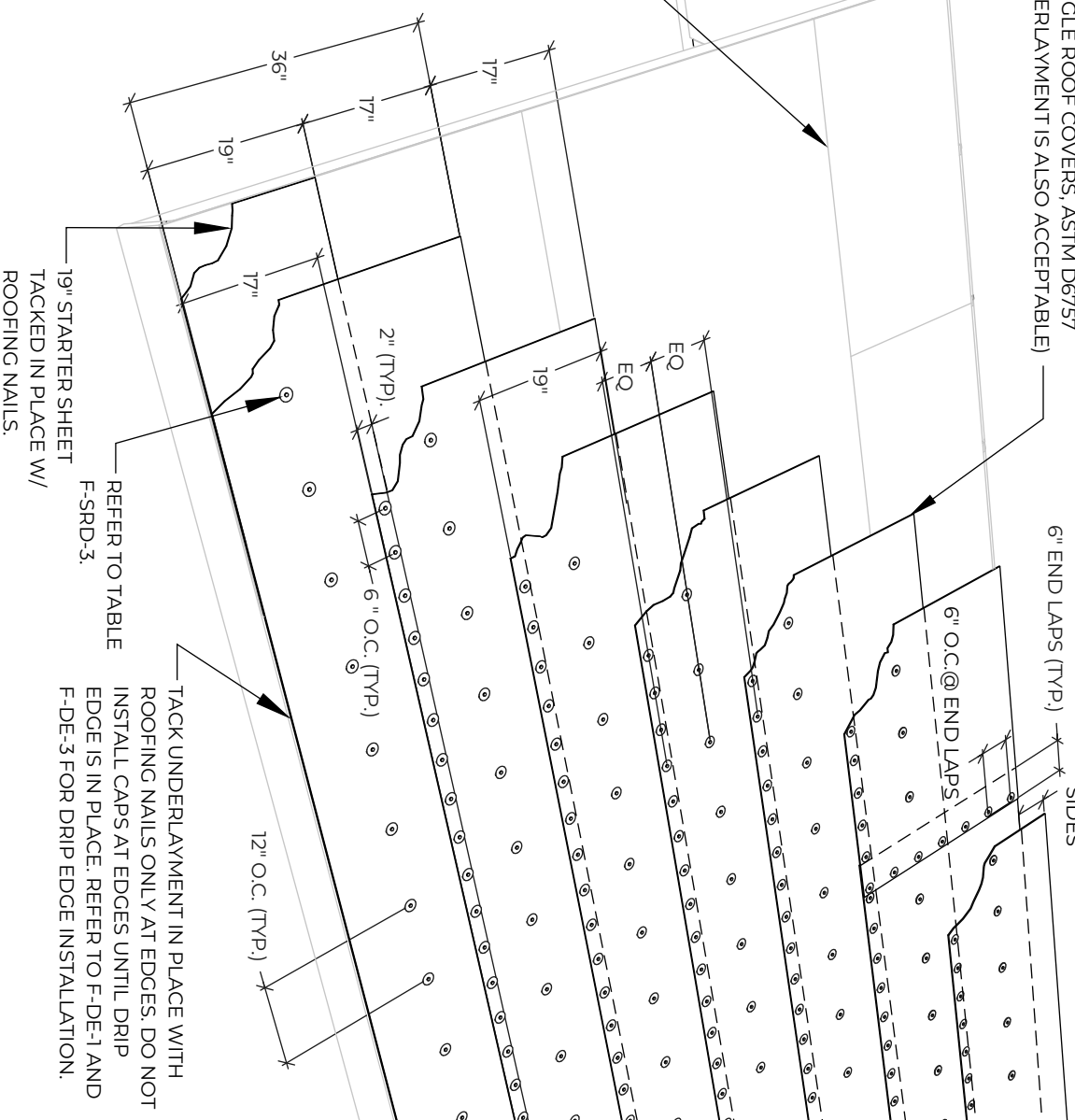
**DESCRIPTION:**

SEALED ROOF DECK - TWO LAYERS
FELT UNDERLAYMENT - SHINGLE OR
METAL ROOF COVERS, STEEP SLOPE

F-SRD-3

11/18/2019



FORTIFIED HOME™ - HURRICANE (2019)
FORTIFIED HOME™ - HIGH WIND (2015)

GENERAL NOTES:

1. REFER TO APPLICABLE FORTIFIED HOME STANDARDS FOR ADDITIONAL INFORMATION.
2. APPLICABLE FOR ROOF PITCH 2:12 OR GREATER.
REFER TO AND INSTALL IN ACCORDANCE WITH MANUFACTURER SPECIFICATIONS AND INSTALLATION INSTRUCTIONS. REFER TO PRODUCT APPROVAL TO VERIFY REQUIRED WIND PRESSURES ARE MET IF APPLICABLE.
3. ADEQUATE ATTIC VENTILATION IS REQUIRED. REFER TO UNDERLAYMENT AND PRIMARY ROOF SYSTEM MANUFACTURER'S INSTALLATION INSTRUCTIONS FOR VENTILATION LIMITATIONS. ALSO CHECK WITH LOCAL BUILDING CODES FOR RESTRICTIONS.
4. FORTIFIED HOME STANDARDS ARE TO BE APPLIED IN CONJUNCTION WITH FEDERAL, STATE, AND LOCAL CODES, ORDINANCES AND REGULATIONS IN ADDITION TO THE STRUCTURAL DESIGN WHICH IS BY OTHERS. IN CASE OF A CONFLICT BETWEEN PROVISIONS, USE WHICHEVER IS MORE STRINGENT.
5.

ASTM D1970 SELF-ADHERING POLYMER-MODIFIED BITUMEN MEMBRANE COVERING ENTIRE ROOF DECK.
REFER TO GENERAL NOTES #3 AND #4.

REFER TO MANUFACTURER'S SPECIFICATIONS FOR REQUIRED OVERLAP AND FOLLOW INSTALLATION INSTRUCTIONS.

STAGGER AND INSTALL END LAPS AS SPECIFIED PER MANUFACTURER'S SPECIFICATIONS AND INSTALLATION INSTRUCTIONS.

ROOF SHEATHING; REFER TO FORTIFIED STANDARD DETAILS F-RS-1, F-RS-2, AND F-RS-3. APPLY MANUFACTURER-SPECIFIED COMPATIBLE PRIMER TO ROOF SHEATHING PER MANUFACTURER INSTALLATION INSTRUCTIONS.

4" MIN. SIDELAPS OR GREATER IF SPECIFIED BY MANUFACTURER'S SPECIFICATIONS AND INSTALLATION INSTRUCTIONS.

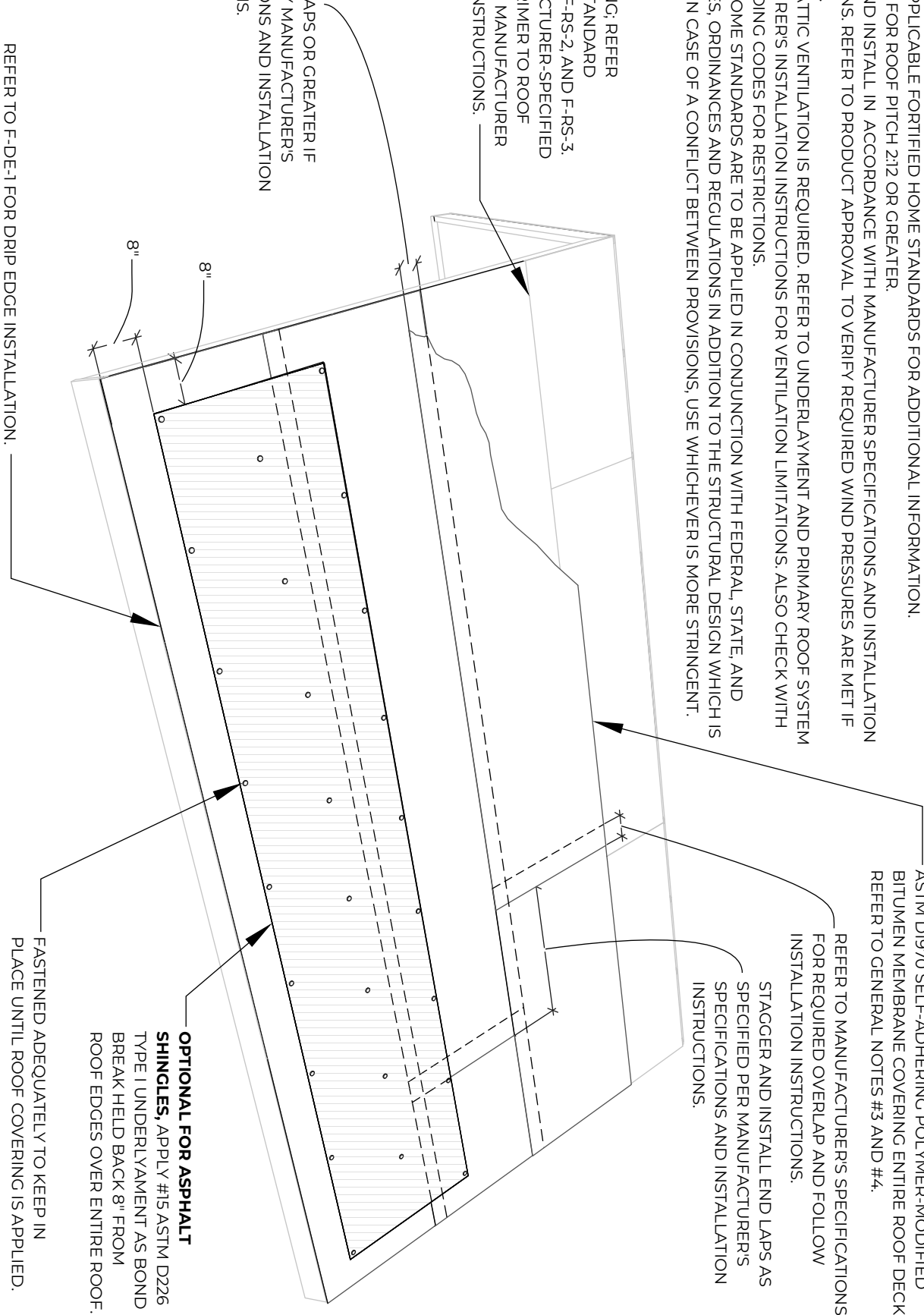

REFER TO F-DE-1 FOR DRIP EDGE INSTALLATION.

APPLICABLE STANDARDS:

FORTIFIED HOME™ - HURRICANE (2019)
FORTIFIED HOME™ - HIGH WIND (2015)

DESCRIPTION:

SEALED ROOF DECK - SELF-ADHERED MEMBRANE (SHOWING BOND BREAK FOR ASPHALT SHINGLES) - SHINGLE, METAL, CONCRETE AND CLAY TILE ROOF COVERS, STEEP SLOPE

DRAWING #:

F-SRD-4

DATE:

11/18/2019



GENERAL NOTES:

1. REFER TO APPLICABLE FORTIFIED HOME STANDARDS FOR ADDITIONAL INFORMATION.
2. REFER TO FORTIFIED STANDARD DETAIL F-C-1 FOR CORROSION PROTECTION REQUIREMENTS.
3. APPLICABLE FOR ROOF PITCH 2:12 OR GREATER. REFER TO AND INSTALL IN ACCORDANCE WITH MANUFACTURER SPECIFICATIONS AND INSTALLATION INSTRUCTIONS. REFER TO PRODUCT APPROVAL TO VERIFY REQUIRED WIND PRESSURES ARE MET IF APPLICABLE.
4. ADEQUATE ATTIC VENTILATION IS REQUIRED. REFER TO UNDERLAYMENT AND PRIMARY ROOF SYSTEM MANUFACTURERS INSTALLATION INSTRUCTIONS FOR VENTILATION LIMITATIONS. ALSO CHECK WITH LOCAL BUILDING CODES FOR RESTRICTIONS.
5. FORTIFIED HOME STANDARDS ARE TO BE APPLIED IN CONJUNCTION WITH FEDERAL, STATE, AND LOCAL CODES, ORDINANCES AND REGULATIONS IN ADDITION TO THE STRUCTURAL DESIGN WHICH IS BY OTHERS. IN CASE OF A CONFLICT BETWEEN PROVISIONS, USE WHICHEVER IS MORE STRINGENT.
- 6.

FLASHING TAPE AT ALL PANEL SEAMS _____ FULLY ADHERED W/ NO WRINKLES OR VOIDS USING ROLLER.

MATERIAL OPTION 1: 4" WIDE ASTM D1970 COMPLIANT SELF-ADHERING POLYMER - MODIFIED BITUMEN FLASHING TAPE.

MATERIAL OPTION 2: 3 - 1/4" WIDE AAMA 711-13 LEVEL 3 (FOR EXPOSURE UP TO 80°C/176°F) COMPLIANT SELF-ADHERING FLASHING TAPE.

ANCHOR SHEET: ASTM D226 TYPE II #30 UNDERLAYMENT.

TACK UNDERLAYMENT IN PLACE WITH ROOFING NAILS ONLY AT EDGES. DO NOT INSTALL CAPS AT EDGES UNTIL DRIP EDGE IS IN PLACE. DRIP EDGE SHALL BE INSTALLED ON TOP OF ANCHOR SHEET PER F-DE-1 AND F-DE-3, BUT UNDER TILE CAP SHEET PER F-DE-2.

ROOF SHEATHING 15/32" MIN.; REFER TO FORTIFIED STANDARD DETAILS F-RS-1, F-RS-2, AND F-RS-3.

6" MIN. OVERLAP FOLDED OVER RIDGE ON BOTH SIDES.

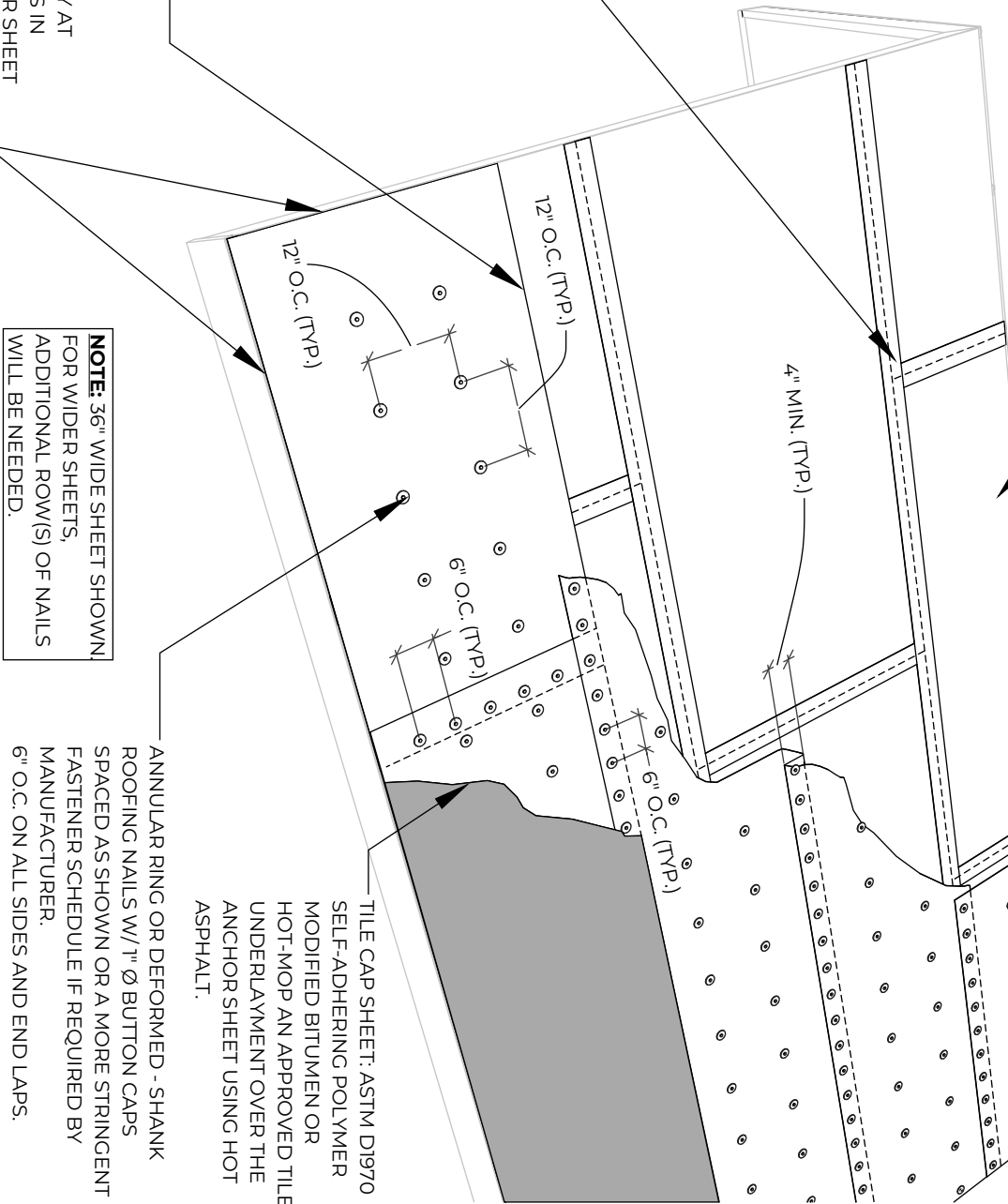

NOTE: 36" WIDE SHEET SHOWN FOR WIDER SHEETS, ADDITIONAL ROW(S) OF NAILS WILL BE NEEDED.

TILE CAP SHEET: ASTM D1970 SELF-ADHERING POLYMER MODIFIED BITUMEN OR HOT-MOP AN APPROVED TILE UNDERLAYMENT OVER THE ANCHOR SHEET USING HOT ASPHALT.

ANNULAR RING OR DEFORMED - SHANK ROOFING NAILS W/ 1" Ø BUTTON CAPS SPACED AS SHOWN OR A MORE STRINGENT FASTENER SCHEDULE IF REQUIRED BY MANUFACTURER.

6" O.C. ON ALL SIDES AND END LAPS.

12" O.C. MAX. BOTH HORIZONTALLY AND VERTICALLY BETWEEN LAPS.

APPLICABLE STANDARDS:

FORTIFIED HOME™ - HURRICANE (2019)
FORTIFIED HOME™ - HIGH WIND (2015)

DESCRIPTION:

SEALED ROOF DECK - FLASHING TAPE, UNDERLAYMENT AND ROOF TILE CAP SHEET - CONCRETE AND CLAY TILE ROOF COVERS, STEEP SLOPE

DRAWING #:

F-SRD-5

DATE:

11/18/2019



GENERAL NOTES:

1. REFER TO APPLICABLE FORTIFIED HOME STANDARDS FOR ADDITIONAL INFORMATION. REFER TO FORTIFIED STANDARD DETAIL F-G-1 FOR CORROSION PROTECTION REQUIREMENTS.
2. BEST PRACTICES TO SEAL THE DRIP EDGE: SINGLE ROOF COVERS; SEAL THE DRIP EDGE, UNDERLAYMENT AND STARTER STRIP AT THE EAVE BY EITHER USING A SELF-ADHERING STARTER STRIP OR APPLYING AN 8" WIDE LAYER OF COMPATIBLE FLASHING CEMENT WITH 1/8" MAX. THICKNESS OVER THE DRIP EDGE AND UNDERLAYMENT.
3. FOR METAL ROOF COVERS, APPLY A COMPATIBLE MANUFACTURER-APPROVED SEALANT BETWEEN THE DRIP EDGE AND ADJACENT UNDERLAYMENT TO PREVENT WATER FROM ACCUMULATING UNDER THE DRIP EDGE OR USE A MANUFACTURER APPROVED 4" SELF-ADHERED SEAM TAPE.
4. APPLICABLE FOR ROOF PITCH 2:12 OR GREATER. FORTIFIED HOME STANDARDS ARE TO BE APPLIED IN CONJUNCTION WITH FEDERAL, STATE, AND LOCAL CODES, ORDINANCES AND REGULATIONS IN ADDITION TO THE STRUCTURAL DESIGN WHICH IS BY OTHERS. IN CASE OF A CONFLICT BETWEEN PROVISIONS, USE WHICHEVER IS MORE STRINGENT.
- 5.

METAL DRIP EDGE (CODE-COMPLIANT, MINIMUM GAUGE) ALONG ALL EAVES AND GABLE RAKE EDGES INSTALLED OVER UNDERLAYMENT. MAKE SURE THE TOP SURFACE OF THE DRIP EDGE IS CLEAN, FREE OF OIL, AND IF REQUIRED BY THE STARTER STRIP MANUFACTURER, PRIMED WITH ASTM D41 PRIMER. FOR SEALING THE DRIP EDGE REFER TO GENERAL NOTE #3.

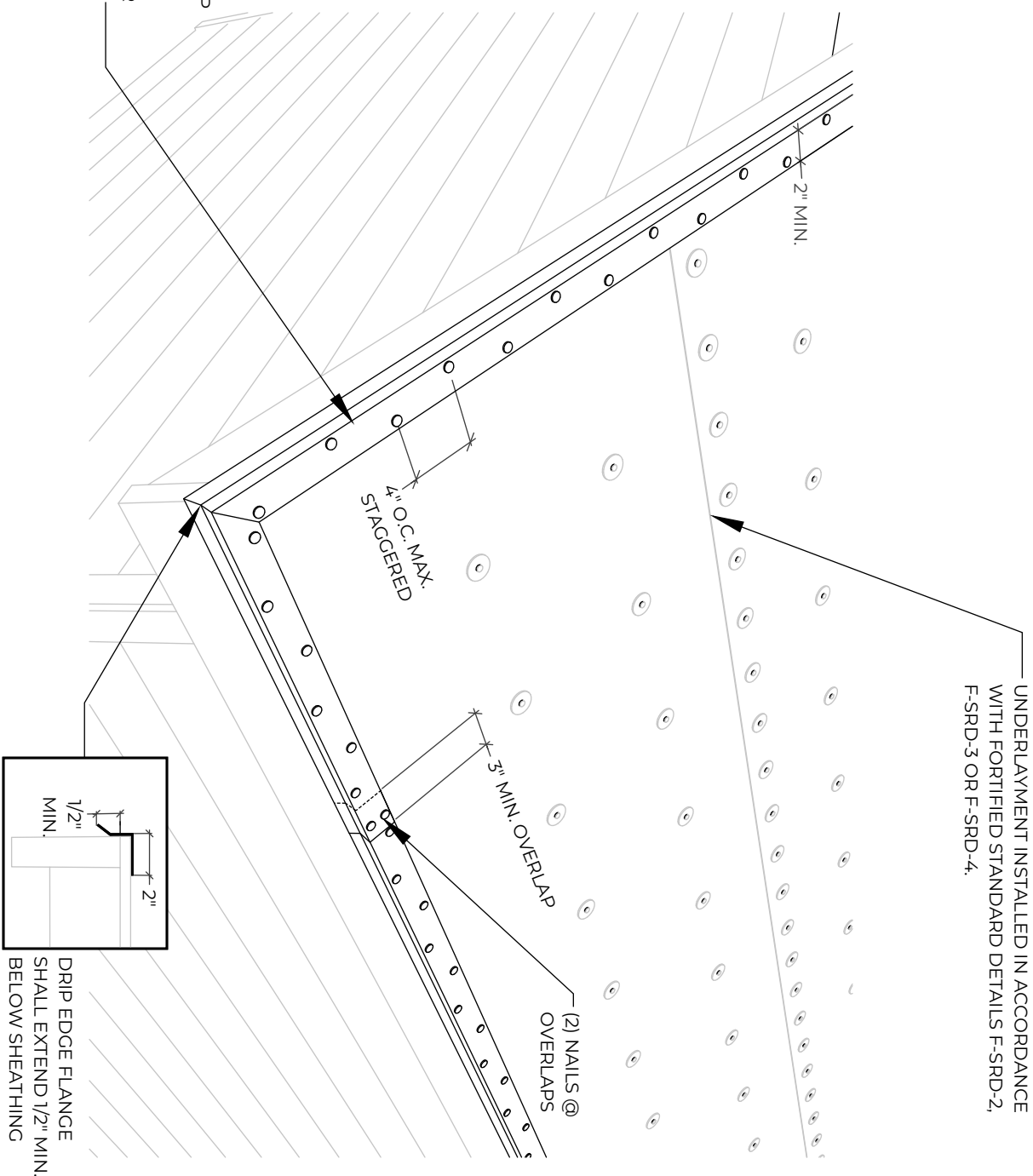

APPLICABLE STANDARDS:

FORTIFIED HOME™ - HURRICANE (2019)

DESCRIPTION:

HURRICANE - DRIP EDGE
INSTALLATION OVER
UNDERLAYMENT

DRAWING #:

F-DE-1

DATE:

11/18/2019



- GENERAL NOTES:
1. REFER TO APPLICABLE FORTIFIED HOME STANDARDS FOR ADDITIONAL INFORMATION. REFER TO FORTIFIED STANDARD DETAIL F-C-1 FOR CORROSION PROTECTION REQUIREMENTS.
 2. APPLICABLE FOR ROOF PITCH 2:12 OR GREATER.
 3. FORTIFIED HOME STANDARDS ARE TO BE APPLIED IN CONJUNCTION WITH FEDERAL, STATE, AND LOCAL CODES, ORDINANCES AND REGULATIONS IN ADDITION TO THE STRUCTURAL DESIGN WHICH IS BY OTHERS. IN CASE OF A CONFLICT BETWEEN PROVISIONS, USE WHICHEVER IS MORE STRINGENT.
 - 4.

AT RAKES, DRIP EDGE INSTALLED OVER ANCHOR SHEET AND CAP SHEET PER FORTIFIED STANDARD DETAILS F-DE-1 OR F-DE-3.

ANCHOR SHEET INSTALLED IN ACCORDANCE WITH FORTIFIED STANDARD DETAIL F-SRD-5.

TILE CAP SHEET INSTALLED IN ACCORDANCE WITH FORTIFIED STANDARD DETAIL F-SRD-5.

AT EAVES, DRIP EDGE INSTALLED OVER ANCHOR SHEET PER FORTIFIED STANDARD DETAILS F-DE-1 OR F-DE-3 BUT UNDER CAP SHEET AS SHOWN.

METAL DRIP EDGE (CODE-COMPLIANT, MINIMUM GAUGE) ALONG ALL EAVES AND GABLE RAKE EDGES INSTALLED OVER UNDERLAYMENT. MAKE SURE THE TOP SURFACE OF THE DRIP EDGE IS CLEAN, FREE OF OIL, AND IF REQUIRED BY THE MEMBRANE MANUFACTURER, PRIMED WITH ASTM D41 PRIMER. REFER TO FORTIFIED STANDARD DETAILS F-DE-1 OR F-DE-3 FOR INSTALLATION OF DRIP EDGE.

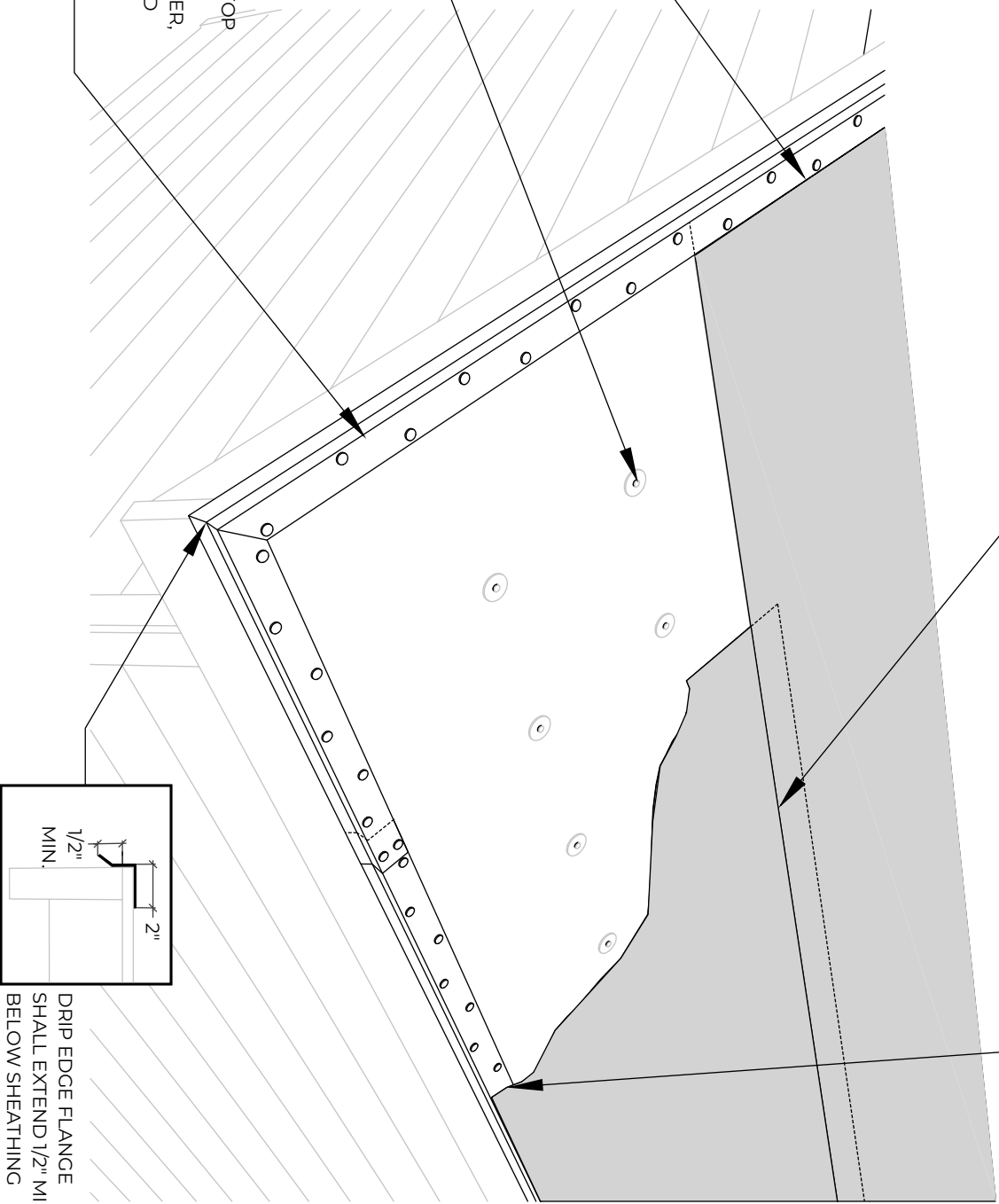

APPLICABLE STANDARDS:

FORTIFIED HOME™ - HURRICANE (2019)
FORTIFIED HOME™ - HIGH WIND (2015)

DESCRIPTION:

DRIP EDGE INSTALLATION OVER ANCHOR SHEET AND UNDER CAP SHEET FOR CONCRETE AND CLAY TILE ROOF COVERS

DRAWING #:

F-DE-2

DATE:

11/18/2019



GENERAL NOTES:

1. REFER TO APPLICABLE FORTIFIED HOME STANDARDS FOR ADDITIONAL INFORMATION. REFER TO FORTIFIED STANDARD DETAIL F-G-1 FOR CORROSION PROTECTION REQUIREMENTS.
2. BEST PRACTICES TO SEAL THE DRIP EDGE: SHINGLE ROOF COVERS; SEAL THE DRIP EDGE, UNDERLAYMENT AND STARTER STRIP AT THE EAVE BY EITHER USING A SELF-ADHERING STARTER STRIP OR APPLYING AN 8" WIDE LAYER OF COMPATIBLE FLASHING CEMENT WITH 1/8" MAX. THICKNESS OVER THE DRIP EDGE AND UNDERLAYMENT.
3. FOR METAL ROOF COVERS, APPLY A COMPATIBLE MANUFACTURER-APPROVED SEALANT BETWEEN THE DRIP EDGE AND ADJACENT UNDERLAYMENT TO PREVENT WATER FROM ACCUMULATING UNDER THE DRIP EDGE OR USE A MANUFACTURER APPROVED 4" SELF-ADHERED SEAM TAPE.
4. APPLICABLE FOR ROOF PITCH 2:12 OR GREATER. FORTIFIED HOME STANDARDS ARE TO BE APPLIED IN CONJUNCTION WITH FEDERAL, STATE, AND LOCAL CODES, ORDINANCES AND REGULATIONS IN ADDITION TO THE STRUCTURAL DESIGN WHICH IS BY OTHERS. IN CASE OF A CONFLICT BETWEEN PROVISIONS, USE WHICHEVER IS MORE STRINGENT.
- 5.

METAL DRIP EDGE (CODE-COMPLIANT, MINIMUM GAUGE) ALONG ALL EAVES AND GABLE RAKE EDGES INSTALLED OVER UNDERLAYMENT. MAKE SURE THE TOP SURFACE OF THE DRIP EDGE IS CLEAN, FREE OF OIL, AND IF REQUIRED BY THE STARTER STRIP MANUFACTURER, PRIMED WITH ASTM D41 PRIMER. FOR SEALING THE DRIP EDGE REFER TO GENERAL NOTE #3.

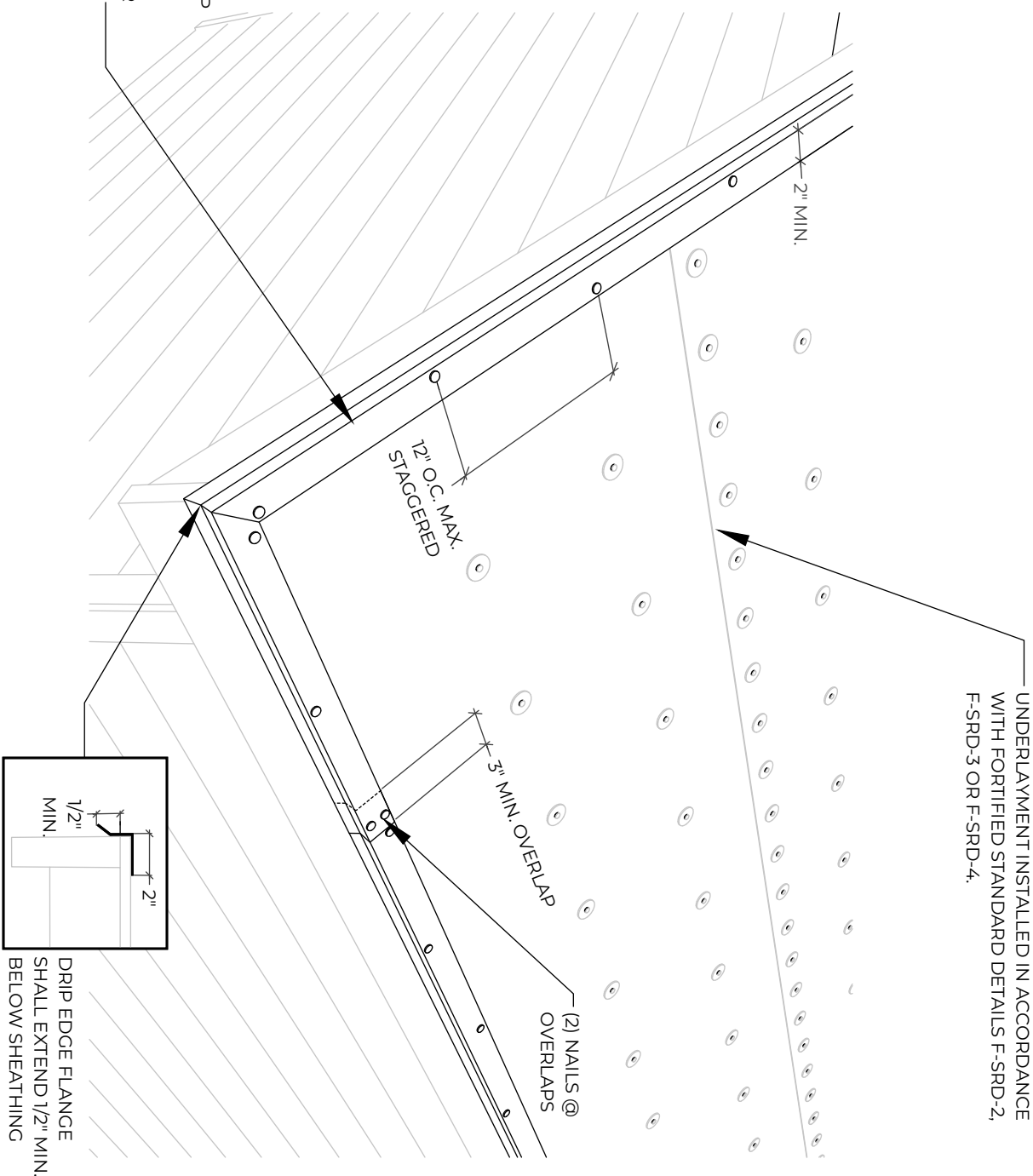

APPLICABLE STANDARDS:

DESCRIPTION:

HIGH WIND - DRIP EDGE
INSTALLATION OVER
UNDERLAYMENT

DRAWING #:

F-DE-3

DATE:

11/18/2019



FORTIFIED HOME™ - HIGH WIND (2015)

GENERAL NOTES:

1. REFER TO APPLICABLE FORTIFIED HOME STANDARDS FOR ADDITIONAL INFORMATION.
2. SHINGLES INSTALLED AT ALL INTERSECTIONS AND BOTH SIDES OF OPEN VALLEYS SHALL BE SET IN A MINIMUM 8 IN. WIDE STRIP OF FLASHING CEMENT (MAX. THICKNESS OF FLASHING CEMENT = 1/8"). CUT SIDE OF CLOSED VALLEYS SHALL BE SET IN A MINIMUM 2 IN. WIDE 1/8" THICK STRIP OF FLASHING CEMENT. WOVEN VALLEYS TO BE ACCORDING TO THE MANUFACTURER'S SPECIFICATIONS.
3. REFER TO FORTIFIED STANDARD DETAILS F-RC-2 AND F-RC-3 FOR ADDITIONAL ASPHALT SHINGLE INSTALLATION OPTIONS. FORTIFIED HOME STANDARDS ARE TO BE APPLIED IN CONJUNCTION WITH FEDERAL, STATE, AND LOCAL CODES, ORDINANCES AND REGULATIONS IN ADDITION TO THE STRUCTURAL DESIGN WHICH IS BY OTHERS. IN CASE OF A CONFLICT BETWEEN PROVISIONS, USE WHICHEVER IS MORE STRINGENT.
- 4.

UNDERLAYMENT INSTALLED PER FORTIFIED STANDARD DETAILS F-SRD-2, F-SRD-3, OR F-SRD-4.

SHINGLE MANUFACTURER APPROVED ASTM D1970 FULLY ADHERED STARTER STRIP WITH ASPHALTIC ADHESIVE STRIP AT EAVE.

D RIP EDGE AND ASTM D41 ASPHALT PRIMER INSTALLED PER FORTIFIED STANDARD DETAIL F-DE-1 OR F-DE-2

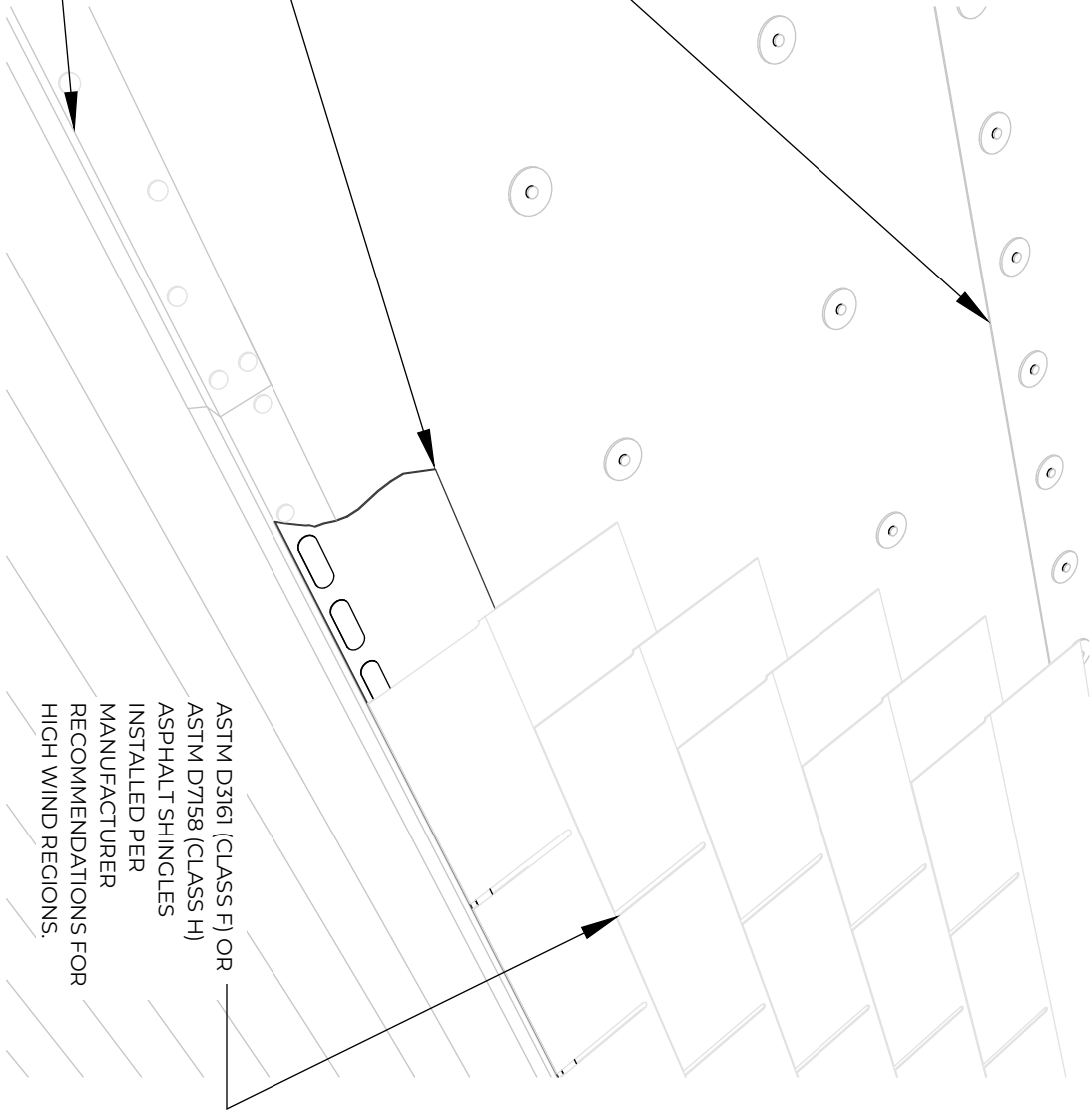

APPLICABLE STANDARDS:

FORTIFIED HOME™ - HURRICANE (2019)
FORTIFIED HOME™ - HIGH WIND (2015)

DESCRIPTION:

ASPHALT SHINGLE INSTALLATION GUIDANCE
FOR STEEP SLOPE - OPTION 1: PEEL AND
STICK STARTER STRIP INSTALLATION AT EAVE
OR RAKE

DRAWING #:

F-RC-1

DATE:

11/18/2019



GENERAL NOTES:

- 1. REFER TO APPLICABLE FORTIFIED HOME STANDARDS FOR ADDITIONAL INFORMATION.
- 2. SHINGLES INSTALLED AT ALL INTERSECTIONS AND BOTH SIDES OF OPEN VALLEYS SHALL BE SET IN A MINIMUM 8 IN. WIDE STRIP OF FLASHING CEMENT (MAX. THICKNESS OF FLASHING CEMENT = 1/8"). CUT SIDE OF CLOSED VALLEYS SHALL BE SET IN A MINIMUM 2 IN. WIDE, 1/8" THICK STRIP OF FLASHING CEMENT. WOVEN VALLEYS TO BE ACCORDING TO THE MANUFACTURERS SPECIFICATIONS.
- 3. REFER TO FORTIFIED STANDARD DETAILS F-RC-1 AND F-RC-3 FOR ADDITIONAL ASPHALT SHINGLE INSTALLATION OPTIONS. FORTIFIED HOME STANDARDS ARE TO BE APPLIED IN CONJUNCTION WITH FEDERAL, STATE, AND LOCAL CODES, ORDINANCES AND REGULATIONS IN ADDITION TO THE STRUCTURAL DESIGN WHICH IS BY OTHERS. IN CASE OF A CONFLICT BETWEEN PROVISIONS, USE WHICHEVER IS MORE STRINGENT.
- 4.

UNDERLAYMENT INSTALLED _____
PER FORTIFIED STANDARD
DETAILS F-SRD-2, F-SRD-3, OR
F-SRD-4.

SHINGLE MANUFACTURER APPROVED _____
STARTER STRIP SET IN A MINIMUM 8 IN.
WIDE STRIP OF COMPATIBLE FLASHING
CEMENT (MAX. THICKNESS OF FLASHING
CEMENT = 1/8").

VERIFY WITH MANUFACTURER THAT _____
FLASHING CEMENT/ROOF MASTIC IS
COMPATIBLE WITH UNDERLAYMENT.

D RIP EDGE AND ASTM D41 ASPHALT
PRIMER INSTALLED PER FORTIFIED
STANDARD DETAIL F-DE-1 OR F-DE-2.

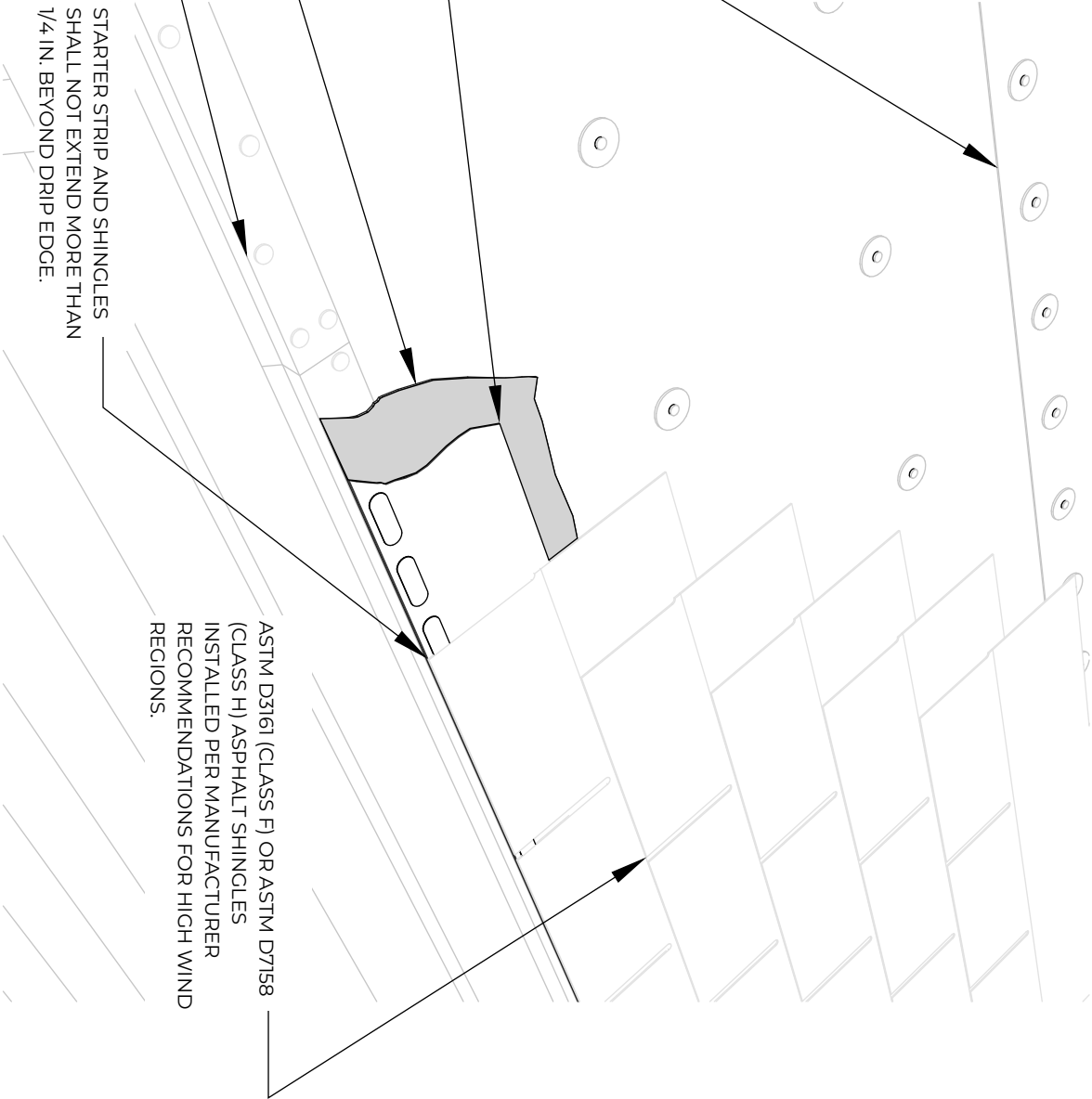

APPLICABLE STANDARDS:

FORTIFIED HOME™ - HURRICANE (2019)
FORTIFIED HOME™ - HIGH WIND (2015)

DESCRIPTION:

ASPHALT SHINGLE INSTALLATION
GUIDANCE FOR STEEP SLOPE -
OPTION 2: SINGLE STRIP STARTER
INSTALLATION AT EAVE OR RAKE

DRAWING #:

F-RC-2

DATE:

11/18/2019



GENERAL NOTES:

1. REFER TO APPLICABLE FORTIFIED HOME STANDARDS FOR ADDITIONAL INFORMATION.
2. SHINGLES INSTALLED AT ALL INTERSECTIONS AND BOTH SIDES OF OPEN VALLEYS SHALL BE SET IN A MINIMUM 8 IN. WIDE STRIP OF FLASHING CEMENT (MAX. THICKNESS OF FLASHING CEMENT = 1/8"). CUT SIDE OF CLOSED VALLEYS SHALL BE SET IN A MINIMUM 2 IN. WIDE, 1/8" THICK STRIP OF FLASHING CEMENT. WOVEN VALLEYS TO BE ACCORDING TO THE MANUFACTURER'S SPECIFICATIONS.
3. REFER TO FORTIFIED STANDARD DETAILS F-RC-1 AND F-RC-2 FOR ADDITIONAL ASPHALT SHINGLE INSTALLATION OPTIONS. FORTIFIED HOME STANDARDS ARE TO BE APPLIED IN CONJUNCTION WITH FEDERAL, STATE, AND LOCAL CODES, ORDINANCES AND REGULATIONS IN ADDITION TO THE STRUCTURAL DESIGN WHICH IS BY OTHERS. IN CASE OF A CONFLICT BETWEEN PROVISIONS, USE WHICHEVER IS MORE STRINGENT.
- 4.

UNDERLAYMENT INSTALLED PER FORTIFIED _____
STANDARD DETAILS F-SRD-2, F-SRD-3, OR F-SRD-4.

D RIP E D G E A N D A S T M D 4 1 A S P H A L T P R I M E R _____
I N S T A L L E D P E R F O R T I F I E D S T A N D A R D
D E T A I L F - D E - 1 O R F - D E - 2 .

S H I N G L E S S E T D I R E C T L Y I N A M I N I M U M 8 I N . W I D E _____
S T R I P O F C O M P A T I B L E F L A S H I N G C E M E N T (M A X .
T H I C K N E S S O F F L A S H I N G C E M E N T = 1 / 8 ") . V E R I F Y
W I T H M A N U F A C T U R E R T H A T F L A S H I N G
C E M E N T / R O O F M A S T I C I S C O M P A T I B L E W I T H
U N D E R L A Y M E N T .

A S T M D 3 1 6 1 (C L A S S F) O R A S T M D 7 1 5 8 (C L A S S H)
A S P H A L T S H I N G L E S I N S T A L L E D P E R M A N U F A C T U R E R
R E C O M M E N D A T I O N S F O R H I G H W I N D R E G I O N S .

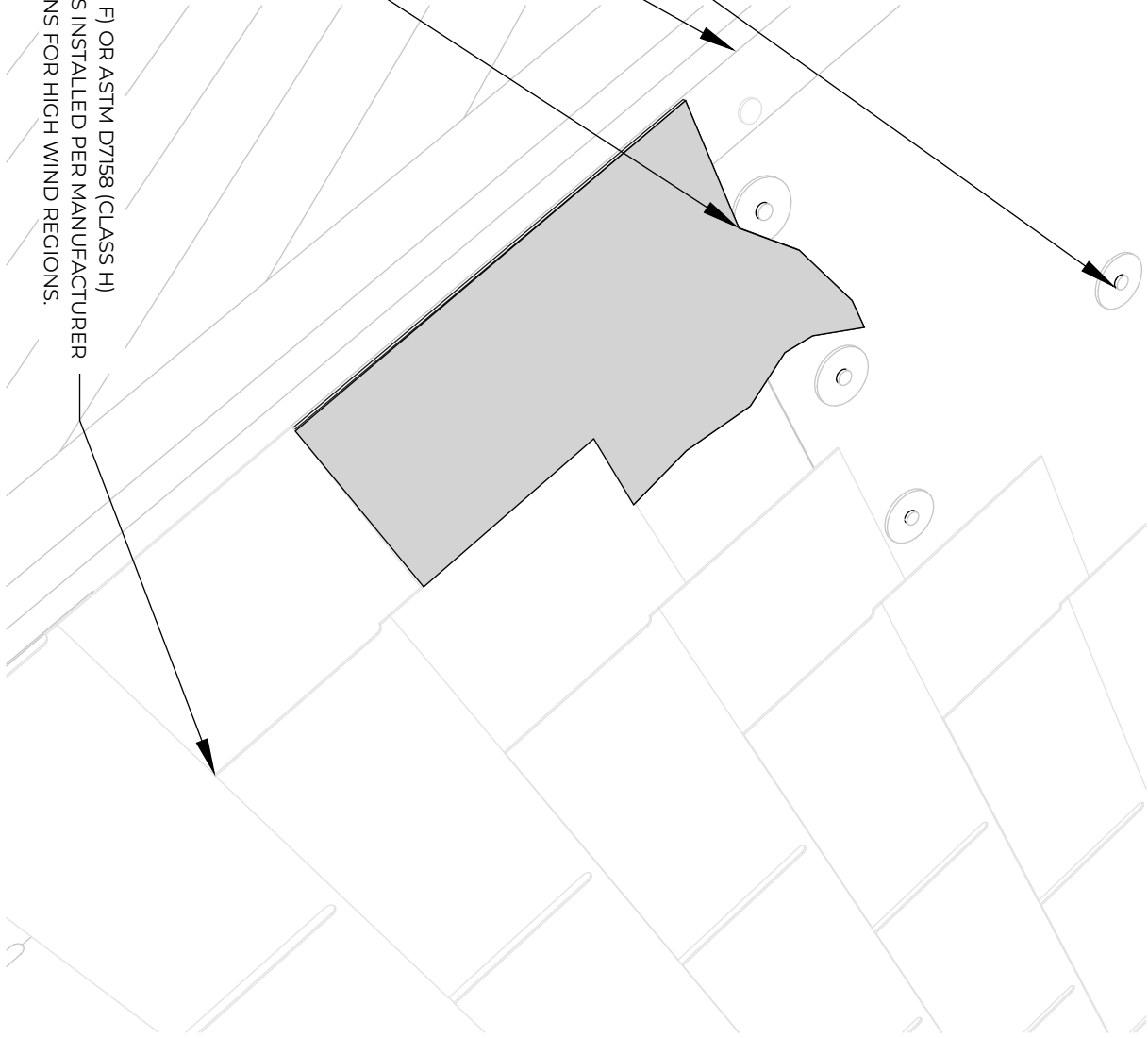

APPLICABLE STANDARDS:

FORTIFIED HOME™ - HURRICANE (2019)
FORTIFIED HOME™ - HIGH WIND (2015)

DESCRIPTION:

ASPHALT SHINGLE INSTALLATION
GUIDANCE FOR STEEP SLOPE - OPTION 3:
SHINGLES SET DIRECTLY IN FLASHING
CEMENT AT RAKE ONLY

DRAWING #:

F-RC-3

DATE:

11/18/2019



GENERAL NOTES:

1. REFER TO APPLICABLE FORTIFIED HOME STANDARDS FOR ADDITIONAL INFORMATION. WHEN REPLACING AN ENTIRE DAMAGED SHEET WITH A DIMENSION OF LESS THAN 24" IN ANY DIRECTION, PROVIDE 2X4 BLOCKING ALONG ALL UNSUPPORTED EDGES, AND FASTEN SHEATHING IN ACCORDANCE WITH F-RR-3 AND F-RR-4.
2. FORTIFIED HOME STANDARDS ARE TO BE APPLIED IN CONJUNCTION WITH FEDERAL, STATE, AND LOCAL CODES, ORDINANCES AND REGULATIONS IN ADDITION TO THE STRUCTURAL DESIGN WHICH IS BY OTHERS. IN CASE OF A CONFLICT BETWEEN PROVISIONS, USE WHICHEVER IS MORE STRINGENT.
- 3.

AT PANEL ENDS, PROVIDE 2 X 4 SCAB FASTENED TO EXISTING MEMBER W/ 16D NAILS @ 4" O.C. STAGGERED, TYP. OF (2).

EXISTING ROOF SHEATHING BY OTHERS W/ 7/16" MIN. THICKNESS AND NO DAMAGE OR DETERIORATION. REFER TO FORTIFIED STANDARD DETAILS F-RR-3 AND F-RR-4 FOR RE-NAILING SCHEDULE.

REFER TO FORTIFIED STANDARD DETAILS F-RR-3 AND F-RR-4 FOR REQUIRED NAILING. ATTACH NEW ROOF DECK TO SCAB (NOT EXISTING ROOF MEMBER), TYP.

PREVIOUSLY DAMAGED ROOF DECK AREA. INSPECT ROOF SUPPORT MEMBERS BELOW FOR DETERIORATION OR DAMAGE AND REPLACE ENTIRE SHEET.

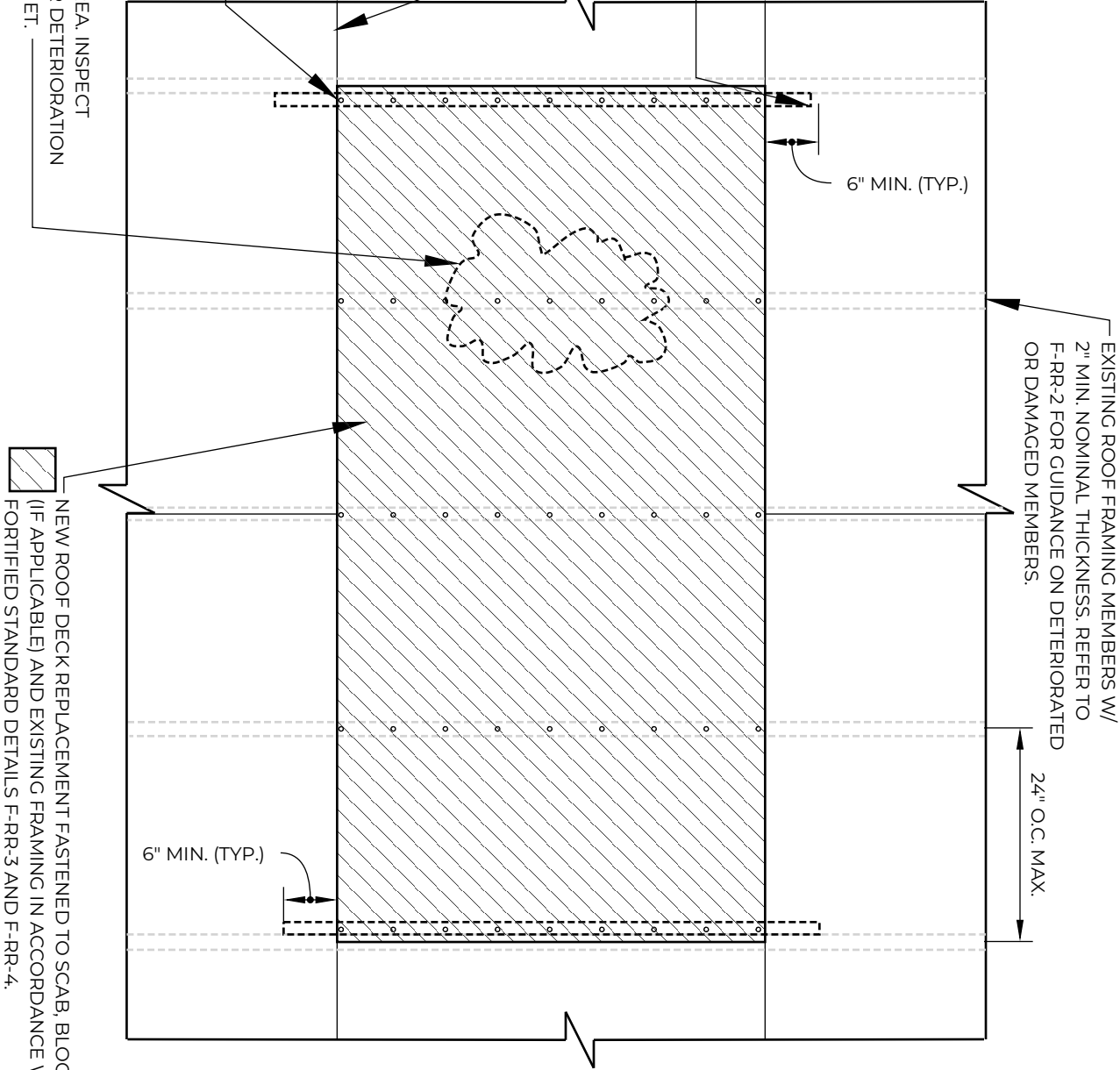

APPLICABLE STANDARDS:

FORTIFIED HOME™ - HURRICANE (2019)
FORTIFIED HOME™ - HIGH WIND (2015)

DESCRIPTION:

RE-ROOFING DECK REPLACEMENT
FASTENING DETAIL

DRAWING #:

F-RR-1

DATE: 11/18/2019



GENERAL NOTES:

1. REFER TO APPLICABLE FORTIFIED HOME STANDARDS FOR ADDITIONAL INFORMATION.
2. SCAB WOOD MEMBERS MAY BE TRIMMED UP TO A MAXIMUM OF 1/2" AT THE BOTTOM TO FACILITATE INSTALLATION.
3. IF DAMAGE IS GREATER THAN THE CONDITIONS SHOWN, CONSULT A LICENSED PROFESSIONAL ENGINEER TO PROVIDE ENGINEERING DETAILS TO REPAIR THE DAMAGE.
4. DAMAGED/DETERIORATED AREA MUST BE A MINIMUM OF 6 IN. AWAY FROM ANY MECHANICAL CONNECTIONS (I.E. TRUSS/RAFTER HANGERS, TRUSS CONNECTOR PLATES, ETC.)
5. WHEN THE FASCIA OR SUB-FASCIA IS THE ROOF FRAMING MEMBER THAT IS DAMAGED OR DETERIORATED, REMOVE AND REPLACE THE DAMAGED/DETERIORATED SECTION PLUS AT LEAST 2 FT. BEYOND THAT SECTION ON EACH SIDE.
6. FORTIFIED HOME STANDARDS ARE TO BE APPLIED IN CONJUNCTION WITH FEDERAL, STATE, AND LOCAL CODES, ORDINANCES AND REGULATIONS IN ADDITION TO THE STRUCTURAL DESIGN WHICH IS BY OTHERS. IN CASE OF A CONFLICT BETWEEN PROVISIONS, USE WHICHEVER IS MORE STRINGENT.

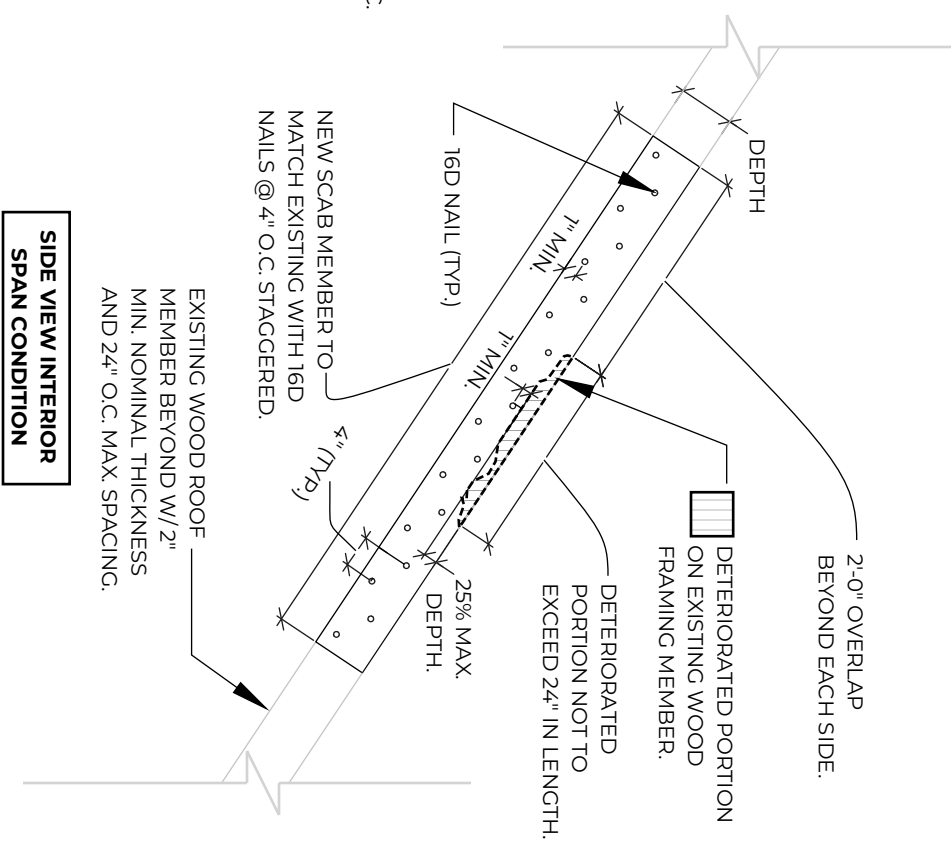
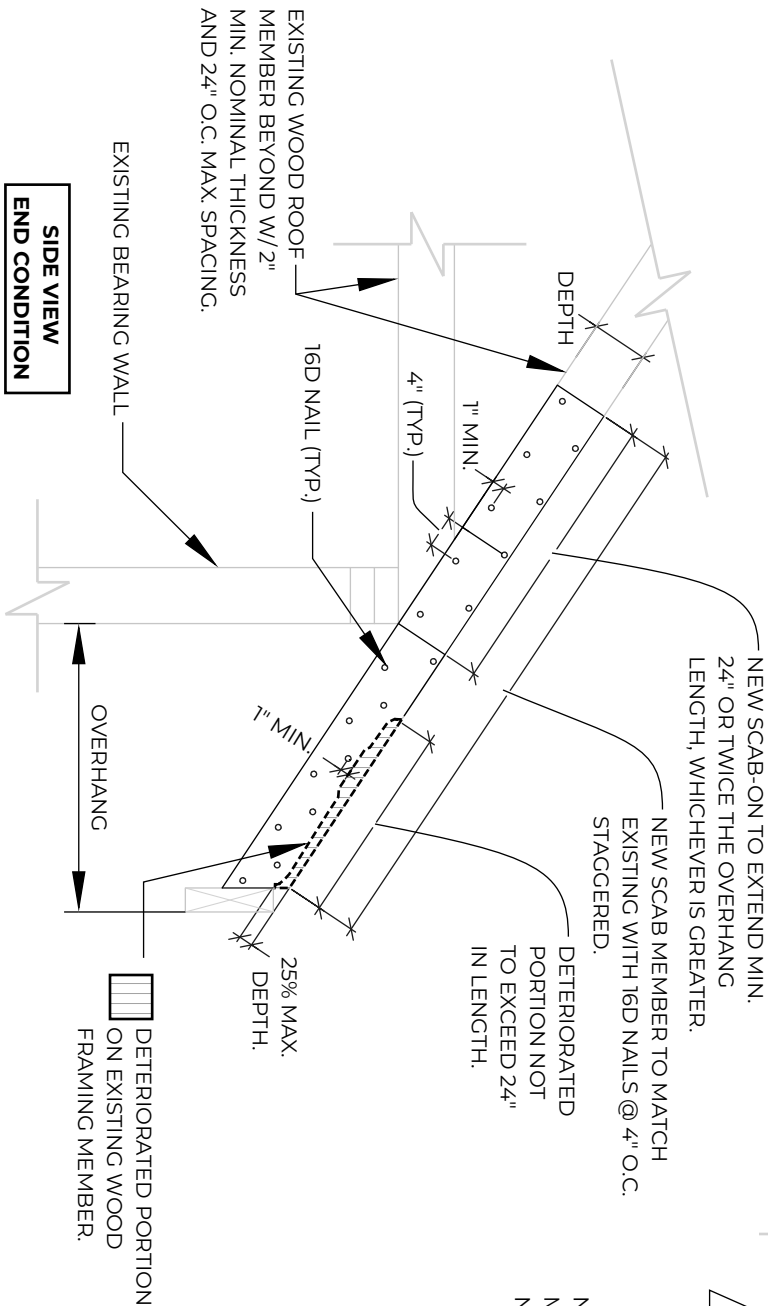

APPLICABLE STANDARDS:

FORTIFIED HOME™ - HURRICANE (2019)
FORTIFIED HOME™ - HIGH WIND (2015)

DESCRIPTION:

RE-ROOFING NEW SCAB MEMBER DETAIL
FOR DAMAGED OR DETERIORATED
WOOD FRAMING MEMBER

DRAWING #:

F-RR-2

DATE:

11/18/2019



GENERAL NOTES:

1. REFER TO APPLICABLE FORTIFIED HOME STANDARDS FOR ADDITIONAL INFORMATION.
2. APPLICABLE FOR ROOF PITCH 2:12 OR GREATER.
3. FORTIFIED HOME STANDARDS ARE TO BE APPLIED IN CONJUNCTION WITH FEDERAL, STATE, AND LOCAL CODES, ORDINANCES AND REGULATIONS IN ADDITION TO THE STRUCTURAL DESIGN WHICH IS BY OTHERS. IN CASE OF A CONFLICT BETWEEN PROVISIONS, USE WHICHEVER IS MORE STRINGENT.

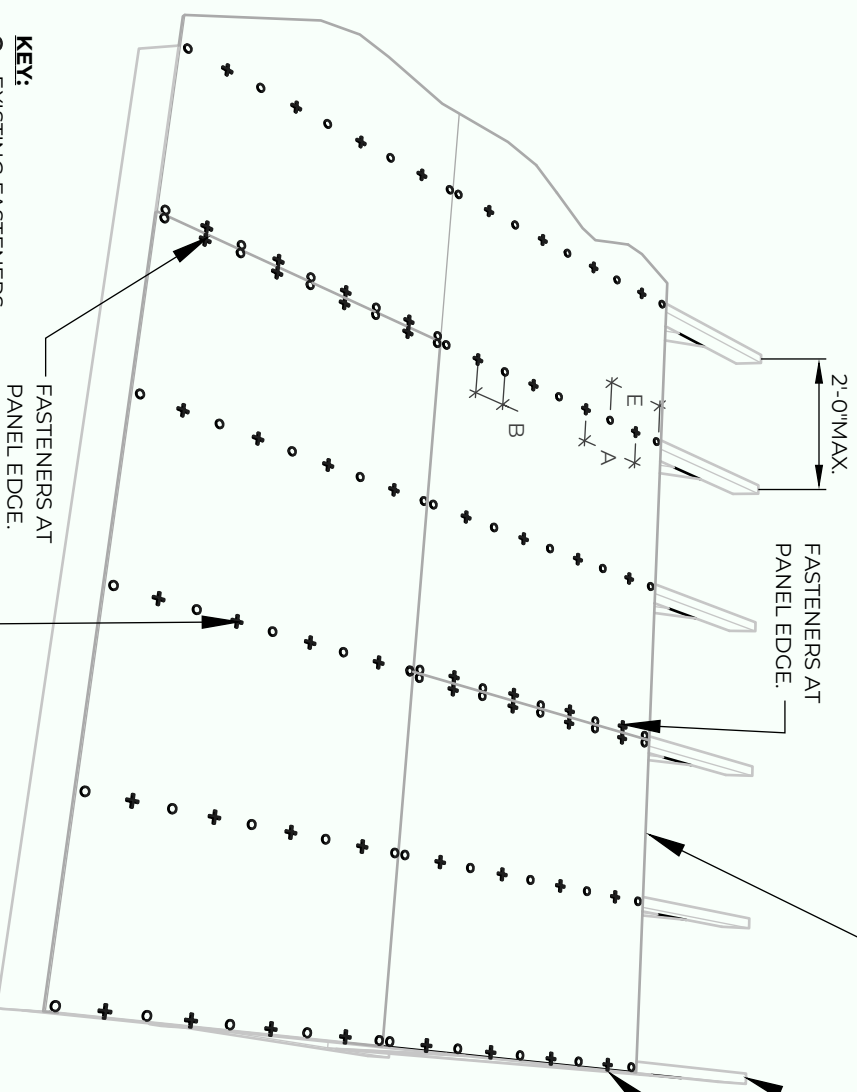

KEY:

- O = EXISTING FASTENERS
- + = ADDITIONAL FASTENERS
- E = SPACING OF EXISTING FASTENERS
- A = SPACING OF ADDITIONAL FASTENERS
- B = SPACING BETWEEN EXISTING AND ADDITIONAL FASTENER

EXISTING STRUCTURAL WOOD PANEL ROOF SHEATHING (PLYWOOD OR OSB): 7/16" MIN. W/ NO DAMAGE OR DETERIORATION. REFER TO F-RR-1 FOR DAMAGED OR DETERIORATED SHEATHING.

EXISTING ROOF FRAMING MEMBERS W/ 2" MIN. NOMINAL THICKNESS. REFER TO F-RR-2 FOR GUIDANCE ON DETERIORATED OR DAMAGED MEMBERS.

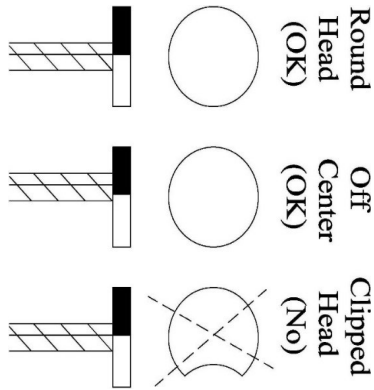

FIGURE 1.

Table F-RR-3: Additional 8d Ring-Shank Nails³ Required for Existing Roof Deck

Wind Speed ⁵	Existing Fastener ² Spacing ⁴ , E	Required Spacing of Additional 8d Ring-Shank Nails ^{3,4}			
		Roof Zones ² 2 and 3		Roof Zone ² 1	
		Intermediate	Intermediate	Intermediate	Intermediate
Up to 100 mph (V_{asd}) / 130 mph (V_{ult})	Existing Fasteners ² Staples or 6d nails	Any			
	8d smooth-shank nails	$E \leq 6"$ O.C.	N/A	$A = 6"$ O.C.	N/A
	8d smooth-shank nails	$E > 6"$ O.C.	$A = 6"$ O.C.	$B = 6"$ O.C.	$B = 6"$ O.C.
	8d ring-shank nails ²	$E \leq 12"$ O.C.		$B = 6"$ O.C.	
Greater than 100 mph (V_{asd}) / 130 mph (V_{ult})	Staples or 6d nails	Any			
	8d smooth-shank nails	$E \leq 6"$ O.C.	$B = 4"$ O.C.	$A = 4"$ O.C.	$A = 6"$ O.C.
	8d smooth-shank nails	$E > 6"$ O.C.	$B = 4"$ O.C.	$A = 4"$ O.C.	$B = 6"$ O.C.
	8d ring-shank nails ²	$E \leq 12"$ O.C.	$B = 4"$ O.C.		$B = 6"$ O.C.

Notes:

1. Refer to FORTIFIED Standard Detail F-G-2 for identification of Roof Zones
2. Existing 8d ring-shank nails to be a minimum of 0.131" diameter x 2 1/2" long.
3. All additional 8d ring-shank nails to be a minimum of 0.113" diameter x 2 3/8" long with full round head. Refer to Figure 1.
4. Refer to roof figure and key for description of distances E, A, and B.
5. V_{asd} corresponds to ASCE 7-05 / V_{ult} corresponds to ASCE 7-10.

APPLICABLE STANDARDS:

FORTIFIED HOME™ - HURRICANE (2019)

DESCRIPTION:

HURRICANE - RE-NAILING THE ROOF DECK (WOOD STRUCTURAL PANELS)

DRAWING #:

F-RR-3

DATE:

11/18/2019



GENERAL NOTES:

1. REFER TO APPLICABLE FORTIFIED HOME STANDARDS FOR ADDITIONAL INFORMATION.
2. APPLICABLE FOR ROOF PITCH 2:12 OR GREATER.
3. SHEATHING THICKNESS REQUIREMENTS:
FOR GOLD DESIGNATION: 7/16" MIN. SHEATHING THICKNESS W/ ROOF MEMBERS @ 24" O.C. MAX. IS REQUIRED.
FOR ROOF/SILVER DESIGNATIONS: 3/8" MIN. SHEATHING THICKNESS IS PERMITTED WHEN ROOF MEMBERS ARE @ 16" O.C. MAX.
4. FORTIFIED HOME STANDARDS ARE TO BE APPLIED IN CONJUNCTION WITH FEDERAL, STATE, AND LOCAL CODES, ORDINANCES AND REGULATIONS IN ADDITION TO THE STRUCTURAL DESIGN WHICH IS BY OTHERS. IN CASE OF A CONFLICT BETWEEN PROVISIONS, USE WHICHEVER IS MORE STRINGENT.

REFER TO GENERAL NOTE
#3 FOR ROOF MEMBER
SPACING REQUIREMENTS

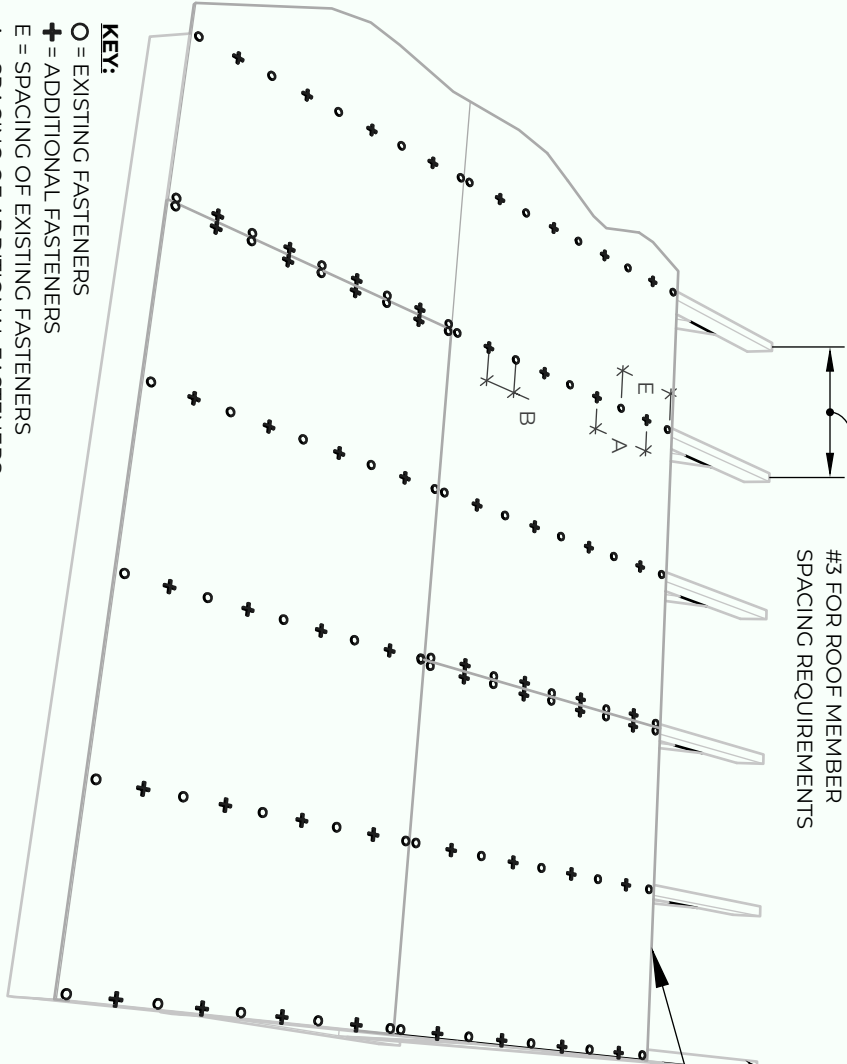

EXISTING ROOF
FRAMING
MEMBERS W/ 2"
MIN. NOMINAL
THICKNESS. REFER
TO F-RR-2 FOR
GUIDANCE ON
DETERIORATED OR
DAMAGED
MEMBERS.

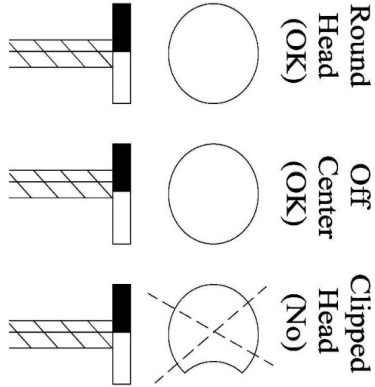

FIGURE 1.

EXISTING STRUCTURAL WOOD PANEL ROOF SHEATHING
(PLYWOOD OR OSB) BY OTHERS W/ NO DAMAGE OR
DETERIORATION. REFER TO F-RR-1 FOR DAMAGED OR
DETERIORATED SHEATHING. REFER TO GENERAL NOTE #3
FOR SHEATHING THICKNESS REQUIREMENTS.

Table F-RR-4: Additional Fasteners Required for Existing Roof Deck

Existing Fasteners ¹	Existing Fastener Spacing, ³ E	Required Spacing of Additional Nails ^{2,3}
Staples, 6d nails, or other fasteners smaller than 8d common nails	Any	8d common nails or 10d box nails @ A = 4" O.C. OR 8d ring shank nails @ A = 6" O.C.
8d smooth-shank nails	E > 4" O.C.	8d ring shank nails @ B ≤ 4" O.C.
8d smooth-shank nails	E ≤ 4" O.C.	N/A
8d ring-shank nails	E ≤ 6" O.C.	N/A

KEY:

- O = EXISTING FASTENERS
- + = ADDITIONAL FASTENERS
- E = SPACING OF EXISTING FASTENERS
- A = SPACING OF ADDITIONAL FASTENERS
- B = SPACING BETWEEN EXISTING AND ADDITIONAL FASTENER

APPLICABLE STANDARDS:

DESCRIPTION:

HIGH WIND - RE-NAILING THE ROOF DECK
(WOOD STRUCTURAL PANELS)

DRAWING #:

F-RR-4

DATE:

11/18/2019



FORTIFIED HOME™ - HIGH WIND (2015)

- GENERAL NOTES:**
REFER TO APPLICABLE FORTIFIED HOME STANDARDS FOR ADDITIONAL INFORMATION.
1. REFER TO FORTIFIED STANDARD DETAIL F-G-1 FOR CORROSION PROTECTION REQUIREMENTS.
 2. FORTIFIED HOME STANDARDS ARE TO BE APPLIED IN CONJUNCTION WITH FEDERAL, STATE, AND LOCAL CODES, ORDINANCES AND REGULATIONS IN ADDITION TO THE STRUCTURAL DESIGN WHICH IS BY OTHERS. IN CASE OF A CONFLICT BETWEEN PROVISIONS, USE WHICHEVER IS MORE STRINGENT.
 - 3.

WOOD STRUCTURAL PANEL OR OTHER NONPOROUS
FLAT SHUTTER CUT TO FIT W/ 7/16" MIN. THICKNESS.
PRE-DRILL HOLES AT FASTENER LOCATIONS. SHAPE
MAY VARY, BUT NOT TO EXCEED MAX. DIMENSIONS
AND FASTENER SPACING SHOWN.

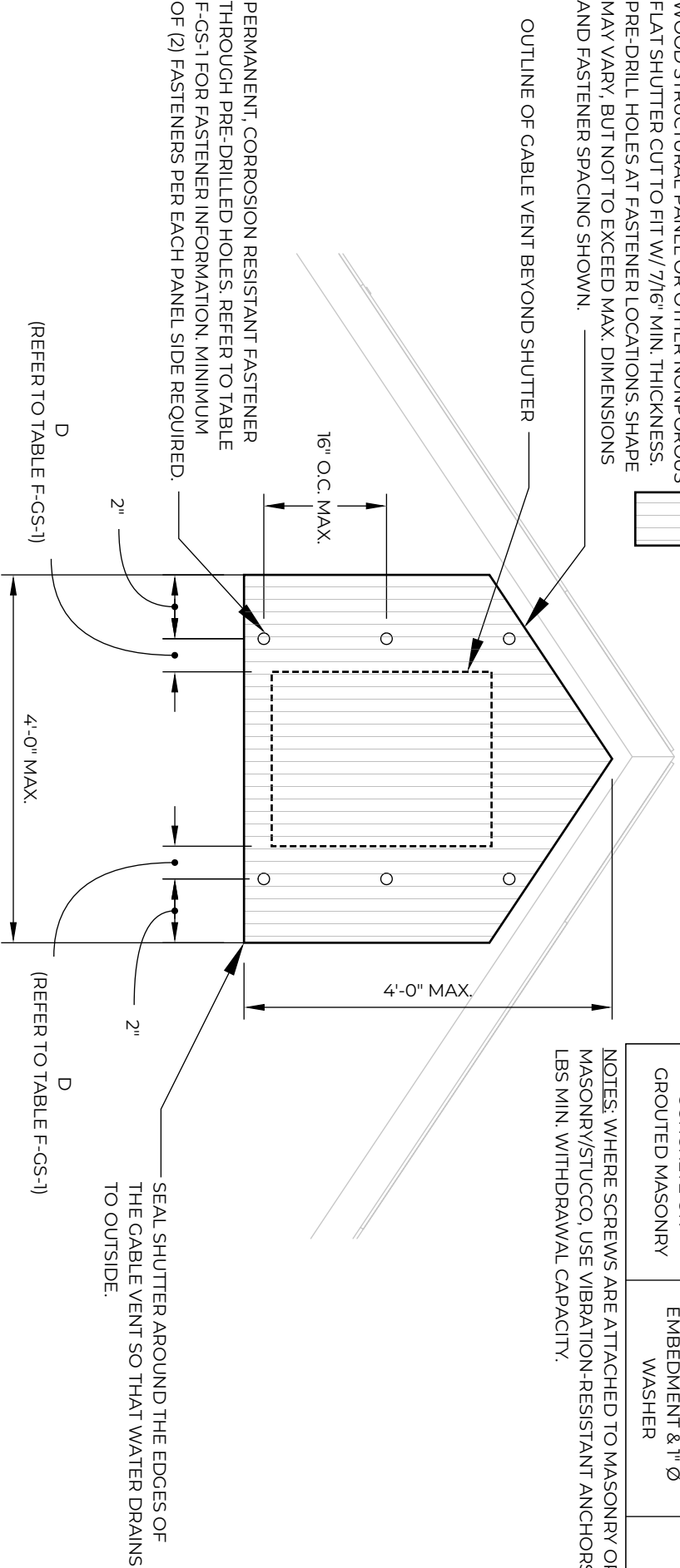

TABLE F-GS-1: FASTENING SCHEDULE FOR CABLE VENT COVER.

SUPPORT STRUCTURE TYPE	FASTENER TYPE & SIZE	END DISTANCE, D
WOOD	1/4" Ø LAG SCREWS W/ 2" EMBEDMENT & 1" Ø WASHER	1"
CONCRETE OR GROUTED MASONRY	1/4" Ø FASTENER W/ 2" EMBEDMENT & 1" Ø WASHER	1.5"

NOTES: WHERE SCREWS ARE ATTACHED TO MASONRY OR MASONRY/STUCCO, USE VIBRATION-RESISTANT ANCHORS W/ 1500 LBS MIN. WITHDRAWAL CAPACITY.

APPLICABLE STANDARDS:

FORTIFIED HOME™ - HURRICANE (2019)

DESCRIPTION:

CABLE VENT SHUTTERING

DRAWING #:

F-GS-1

DATE:

11/18/2019

